

ANGLE HOSE VALVE

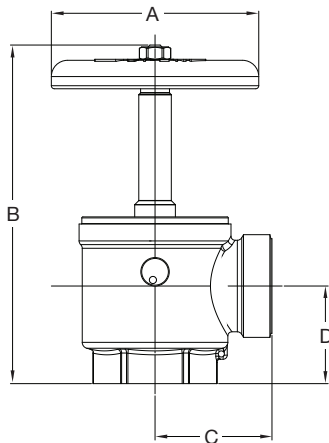

MODEL: SHIELD-AV

- Used with hose rack assembly or as a fire department outlet connection
- Double Female NPT inlet and outlet or Female NPT inlet x male NH (NST) hose thread outlet standard connections
- Forged brass valve body with red hand wheel
- Working pressure of 300 psi
- Maximum test pressure of 600 psi
- Optional finishes - polished brass, royal chrome plated, polished chrome plated



Female x Male

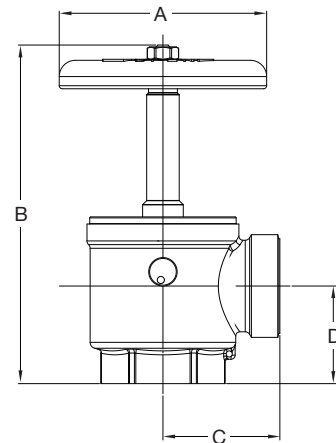

Double Female

		1½" x 1½"	2½" x 2½"
A		102	130.17
B		195.26	268.28
C	Double Female	54.37	80.16
	Female x Male	57.54	80.96
D		48.02	67.07

Unit : mm