

FOAM PUMP

MODEL: SD-FP-30

DESCRIPTION

SD-FP-30, is specialized non-corrosive construction pumps used for Fire Protection, especially for Fire-fighting foam concentrate pumping & Water mist pumping applications. These pumps can also be used for Stationary or mobile systems applications.

SHIELD Foam pump have 255 Duplex Stainless steel shafts to withstand seawater flush and any brand foam concentrate. Only 1 shaft seal is permitted and shaft seal shall be capable of dry operation for 10 minutes. Shaft seal shall be simple to repair and replace in the field. Shaft seal materials are 316 stainless casing with double PTFE lips that allow for hydro test pressure to 350 psig without leakage.

Pump rotor shall be spur gear design using corrosion resistant materials. Made from admiralty bronze alloy and composite materials that provide no tooth to tooth wear and no corrosion.

Foam pump connections shall be Groove or Threaded. Pump connections and end covers shall use O-ring seals for leak free operation and simple field replacement.

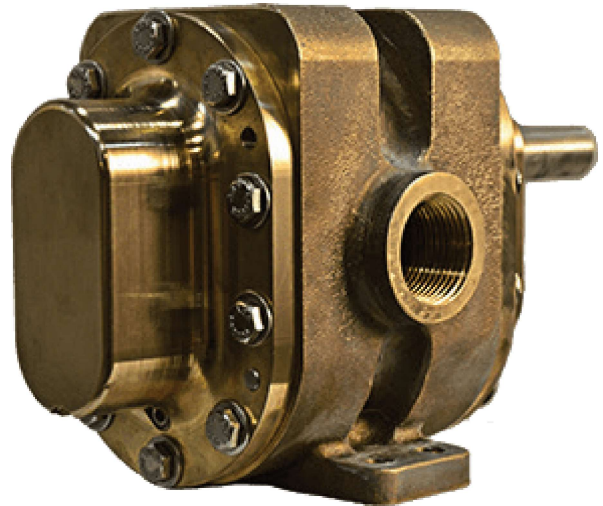

TECHNICAL INFORMATION

RPM	1500	1800
Flow GPM (LPM)	24-36 (91-136)	40-55(152-208)
Pressure psi(kg/cm ²)	261-100(18-7)	261-100(18-7)
Port Size (inch)	1x1	1x1
Material (Body)	Bronze	
Pump Rotor	Spur	
Shaft Type	Key Shaft or Splined Input Shaft	
Type of Connection	Threading, Grooved	
Material (Shaft)	255 Duplex Stainless Steel Shafts	

FEATURES

- Pump is quiet and smooth operation during operation.
- Pump shafts is supported by composite bushings that are field replaceable and capable of extended operation on water or foam concentrate.
- Foam pump design is utilize replaceable casing liners, bearings or timing gears.
- Capable of rotation in either direction without modification.
- UL LISTED & capable of 261(18 bar) psig operation.

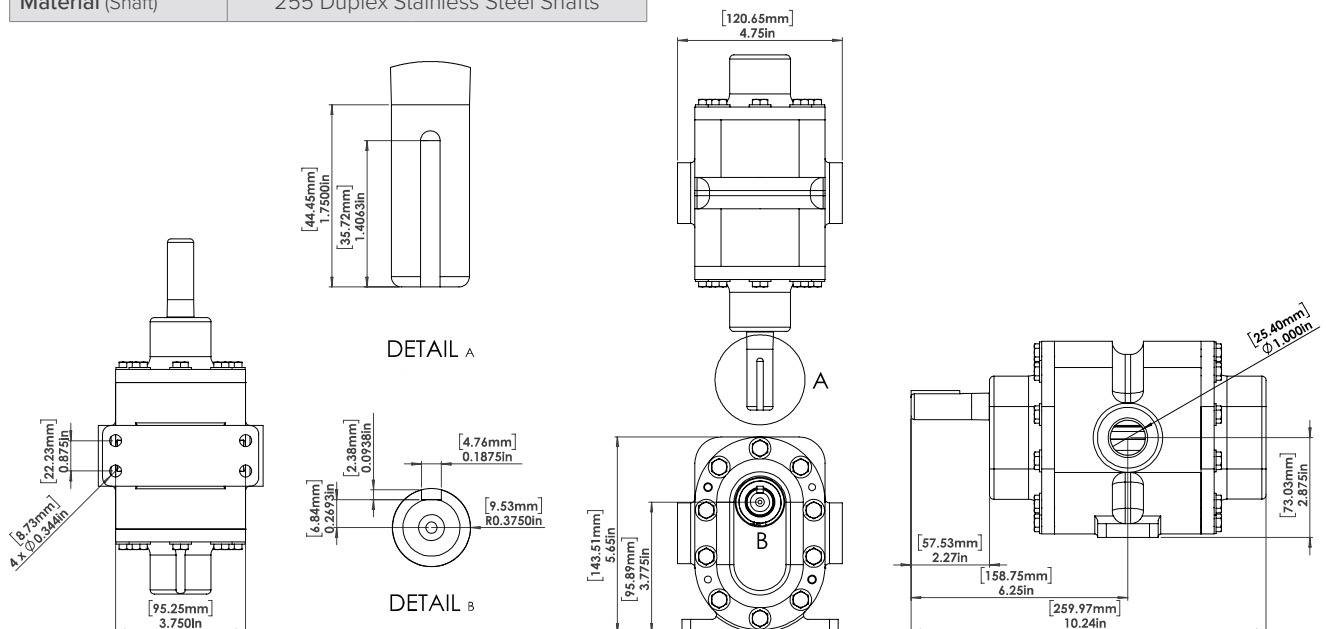

POWER REQUIRED VS DISCHARGE PRESSURE

PORT SIZE: 1" x 1"

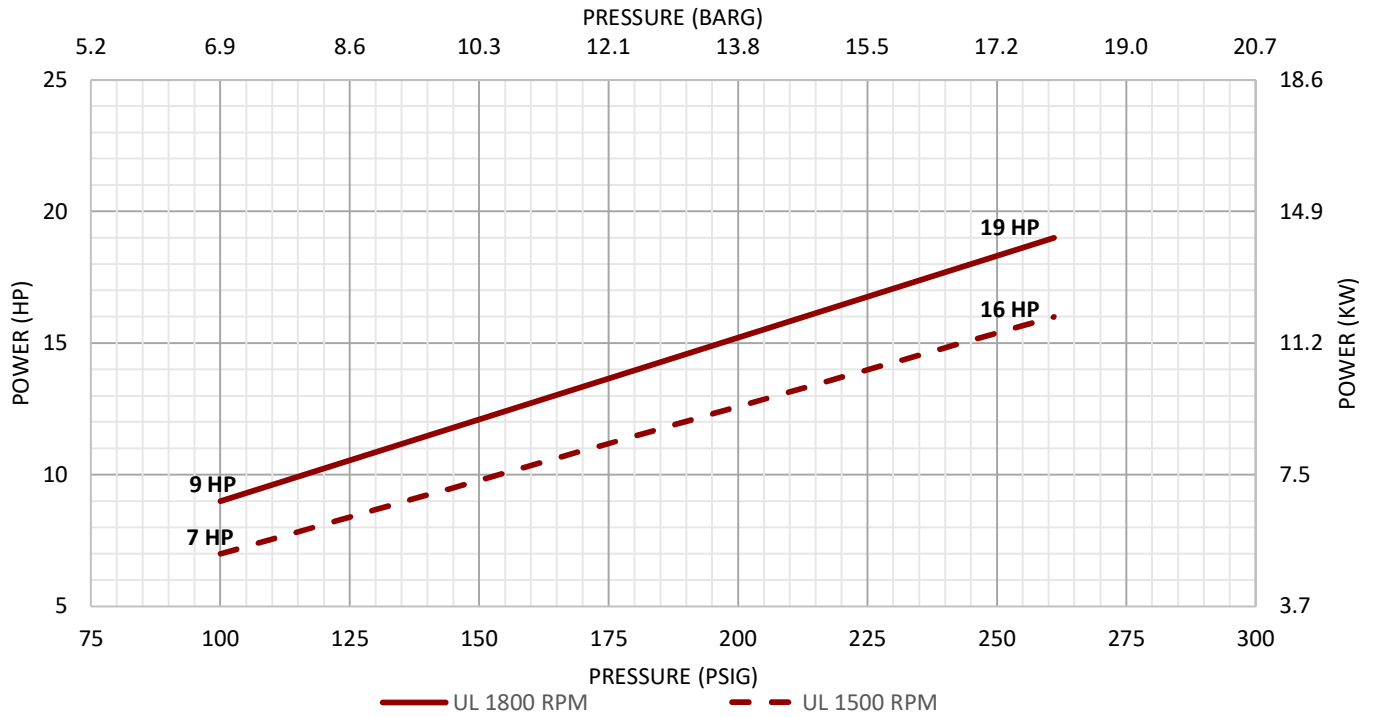

FLOWRATE VS DISCHARGE PRESSURE

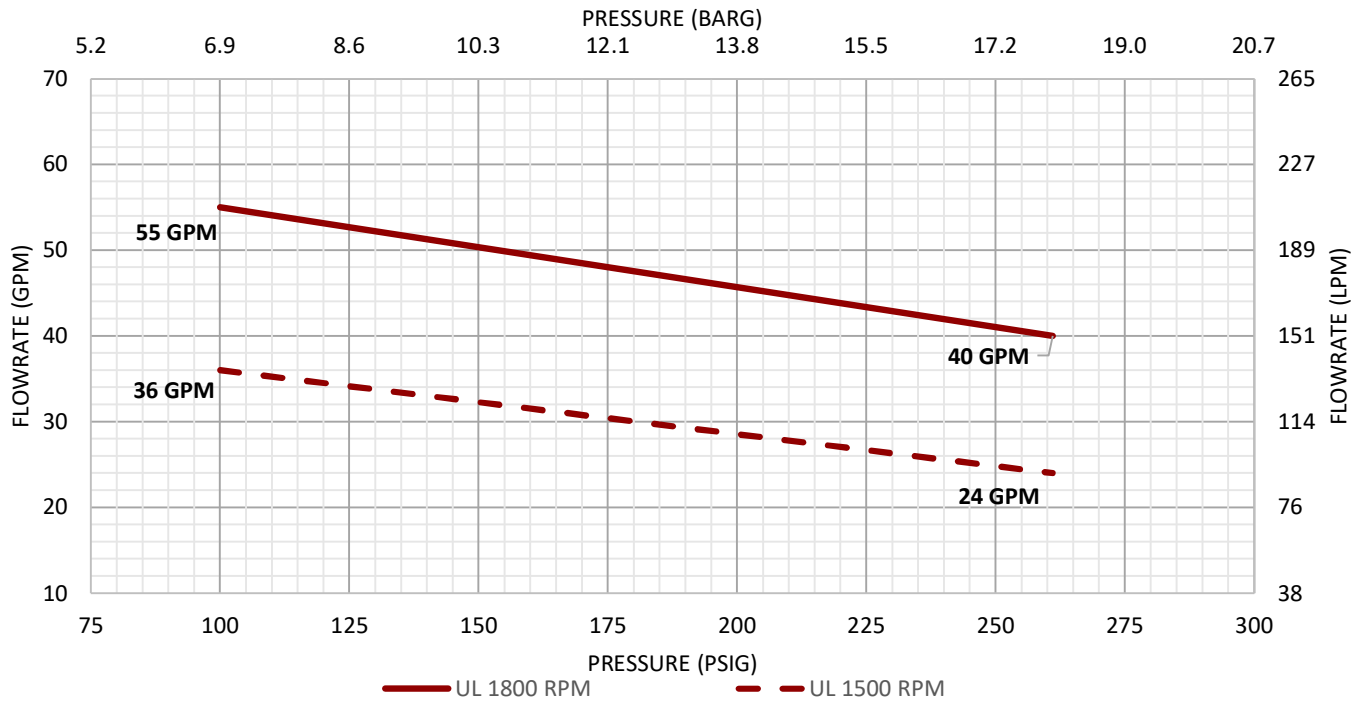

FOAM PUMP

MODEL: SD-FP-50

DESCRIPTION

SD-FP-50, is specialized non-corrosive construction pumps used for Fire Protection, especially for Fire-fighting foam concentrate pumping & Water mist pumping applications. These pumps can also be used for Stationary or mobile systems applications.

SHIELD Foam pump have 255 Duplex Stainless steel shafts to withstand seawater flush and any brand foam concentrate. Only 1 shaft seal is permitted and shaft seal shall be capable of dry operation for 10 minutes. Shaft seal shall be simple to repair and replace in the field. Shaft seal materials are 316 stainless casing with double PTFE lips that allow for hydro test pressure to 350 psig without leakage.

Pump rotor shall be spur gear design using corrosion resistant materials. Made from admiralty bronze alloy and composite materials that provide no tooth to tooth wear and no corrosion.

Foam pump connections shall be Groove or Threaded. Pump connections and end covers shall use O-ring seals for leak free operation and simple field replacement.

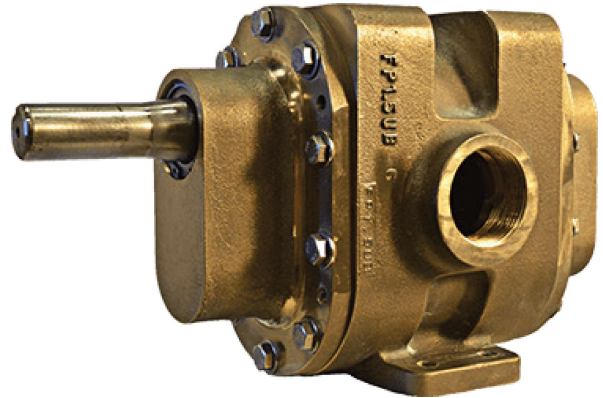

TECHNICAL INFORMATION

RPM	1500	1800
Flow GPM (LPM)	40-56 (151-212)	57-72 (215-273)
Pressure psi(kg/cm ²)	261-100(18-7)	261-100(18-7)
Port Size (inch)	1.5x1.5	1.5x1.5
Material (Body)	Bronze	
Pump Rotor	Spur	
Shaft Type	Key Shaft or Splined Input Shaft	
Type of Connection	Threading, Grooved	
Material (Shaft)	255 Duplex Stainless Steel Shafts	

FEATURES

- Pump is quiet and smooth operation during operation.
- Pump shafts is supported by composite bushings that are field replaceable and capable of extended operation on water or foam concentrate.
- Foam pump design is utilize replaceable casing liners, bearings or timing gears.
- Capable of rotation in either direction without modification.
- UL LISTED & capable of 261(18 bar)psig operation.

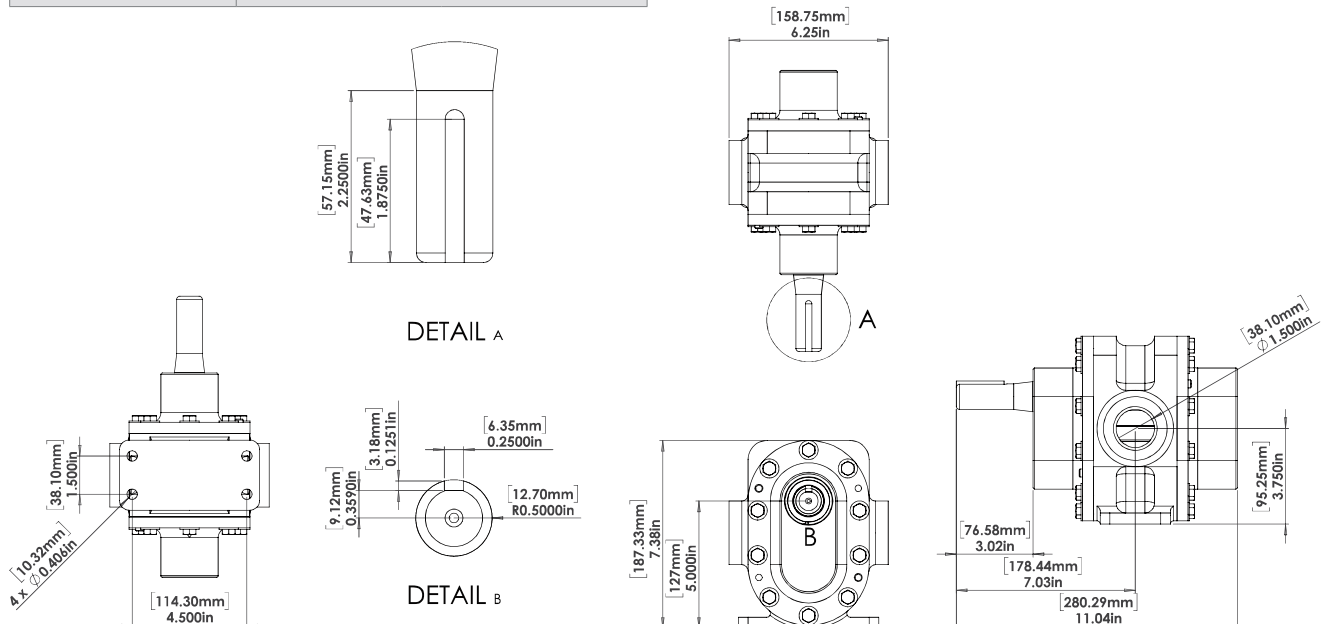

POWER REQUIRED VS DISCHARGE PRESSURE

PORT SIZE: 1.5"x1.5"

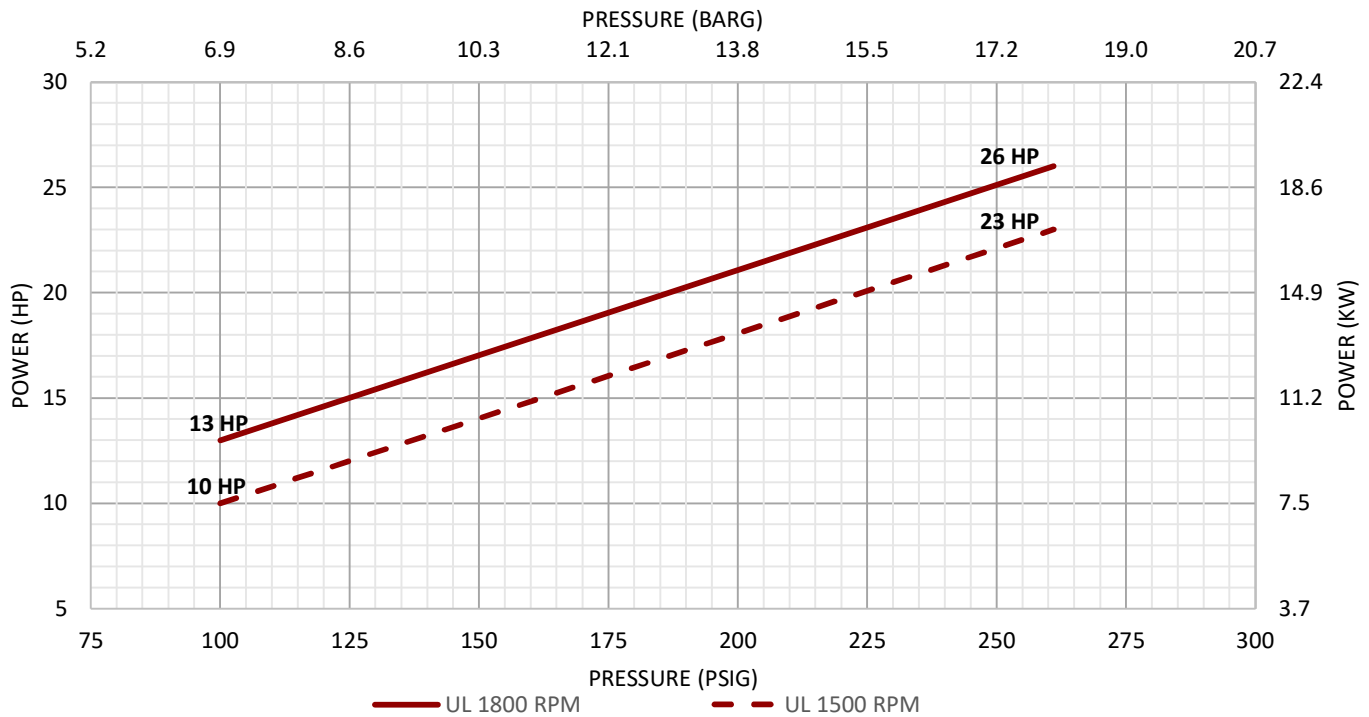

FLOWRATE VS DISCHARGE PRESSURE

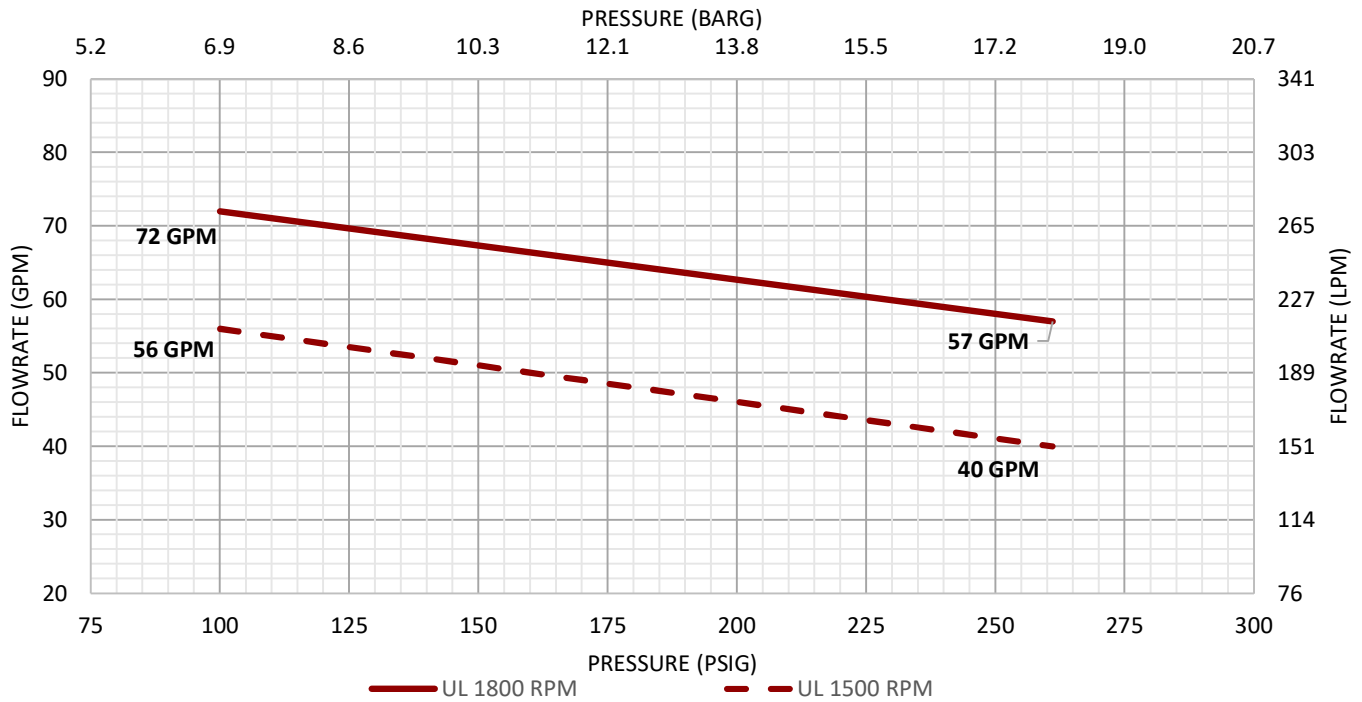

REV-C

FOAM PUMP

MODEL: SD-FP-75

DESCRIPTION

SD-FP-75, is specialized non-corrosive construction pumps used for Fire Protection, especially for Fire-fighting foam concentrate pumping & Water mist pumping applications. These pumps can also be used for Stationary or mobile systems applications.

SHIELD Foam pump have 255 Duplex Stainless steel shafts to withstand seawater flush and any brand foam concentrate. Only 1 shaft seal is permitted and shaft seal shall be capable of dry operation for 10 minutes. Shaft seal shall be simple to repair and replace in the field. Shaft seal materials are 316 stainless casing with double PTFE lips that allow for hydro test pressure to 350 psig without leakage.

Pump rotors shall be spur gear design using corrosion resistant materials. Made from admiralty bronze alloy and composite materials that provide no tooth to tooth wear and no corrosion.

Foam pump connections shall be Groove or Threaded. Pump connections and end covers shall use O-ring seals for leak free operation and simple field replacement.

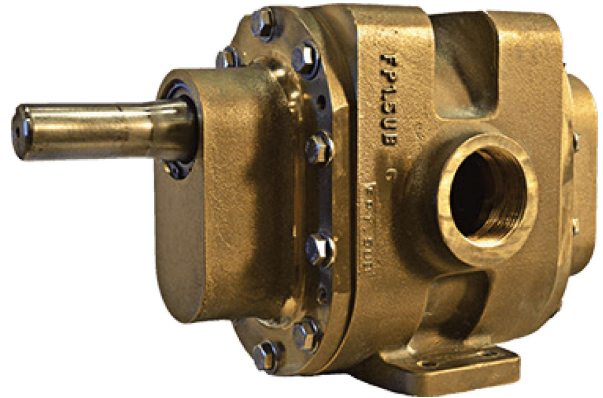

TECHNICAL INFORMATION

RPM	1500	1800
Flow GPM (LPM)	65-90 (246-341)	90-115(341-436)
Pressure psi(kg/cm ²)	261-100(18-7)	261-100(18-7)
Port Size (inch)	1.5x1.5	1.5x1.5
Material (Body)	Bronze	
Pump Rotor	Spur	
Shaft Type	Key Shaft or Splined Input Shaft	
Type of Connection	Threading, Grooved	
Material (Shaft)	255 Duplex Stainless Steel Shafts	

FEATURES

- Pump is quiet and smooth operation during operation.
- Pump shafts is supported by composite bushings that are field replaceable and capable of extended operation on water or foam concentrate.
- Foam pump design is utilize replaceable casing liners, bearings or timing gears.
- Capable of rotation in either direction without modification.
- UL LISTED & capable of 261(18 bar)psig operation.

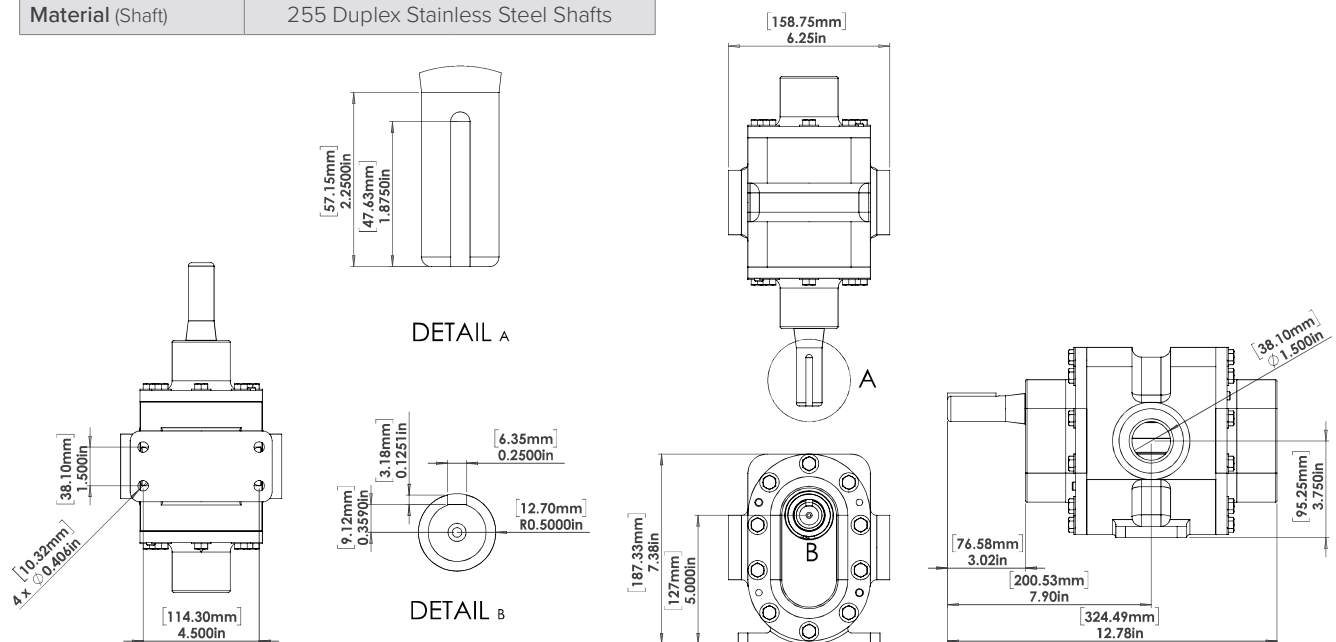

POWER REQUIRED VS DISCHARGE PRESSURE

PORT SIZE: 1.5"x1.5"

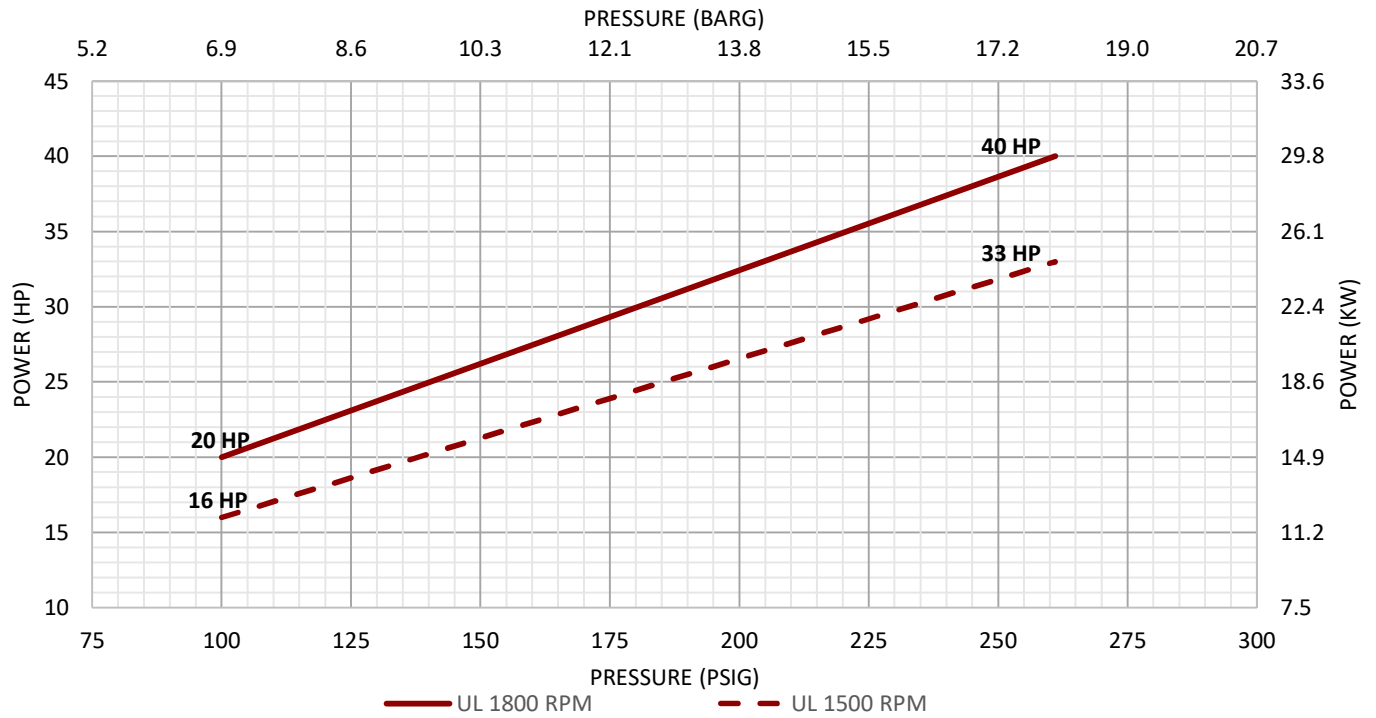

FLOWRATE VS DISCHARGE PRESSURE

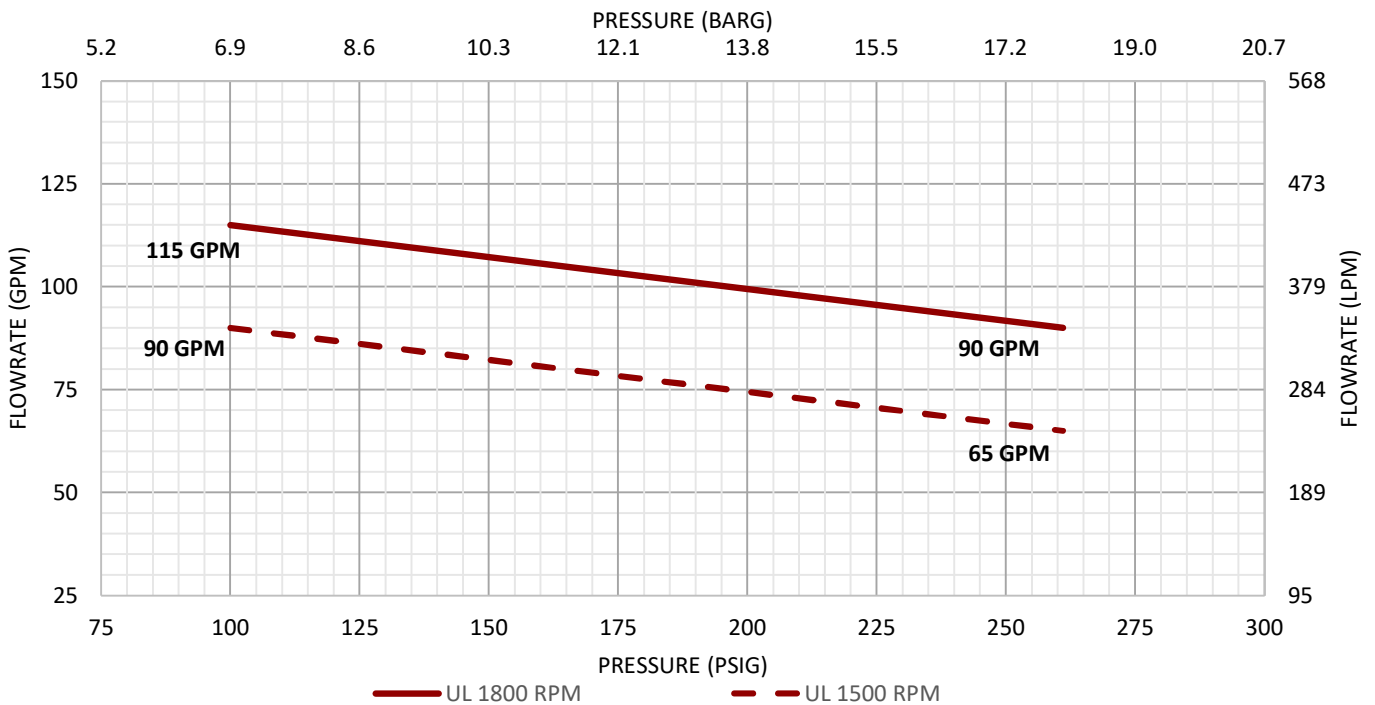

FOAM PUMP

MODEL: SD-FP-101

DESCRIPTION

SD-FP-101, is specialized non-corrosive construction pumps used for Fire Protection, especially for Fire-fighting foam concentrate pumping & Water mist pumping applications. These pumps can also be used for Stationary or mobile systems applications.

SHIELD Foam pump have 255 Duplex Stainless steel shafts to withstand seawater flush and any brand foam concentrate. Only 1 shaft seal is permitted and shaft seal shall be capable of dry operation for 10 minutes. Shaft seal shall be simple to repair and replace in the field. Shaft seal materials are 316 stainless casing with double PTFE lips that allow for hydro test pressure to 350 psig without leakage.

Pump rotors shall be Herringbone gear design using corrosion resistant materials. Made from admiralty bronze alloy and composite materials that provide no tooth to tooth wear and no corrosion.

Foam pump connections shall be Groove or Flanged. Pump connections and end covers shall use O-ring seals for leak free operation and simple field replacement.

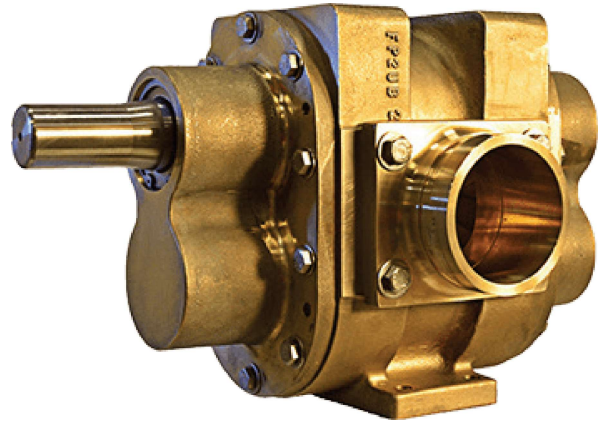

TECHNICAL INFORMATION

RPM	1500	1800
Flow GPM (LPM)	88-119 (334-451)	121-152(459-576)
Pressure psi(kg/cm ²)	261-100(18-7)	261-100(18-7)
Port Size (inch)	2x2	2x2
Material (Body)	Bronze	
Pump Rotor	Herringbone Gear	
Shaft Type	Key Shaft or Splined Input Shaft	
Type of Connection	Flanged, Grooved	
Material (Shaft)	255 Duplex Stainless Steel Shafts	

FEATURES

- Pump is quiet and smooth operation during operation.
- Pump shafts is supported by composite bushings that are field replaceable and capable of extended operation on water or foam concentrate.
- Foam pump design is utilize replaceable casing liners, bearings or timing gears.
- Capable of rotation in either direction without modification.
- UL LISTED & capable of 261(18 bar)psig operation.

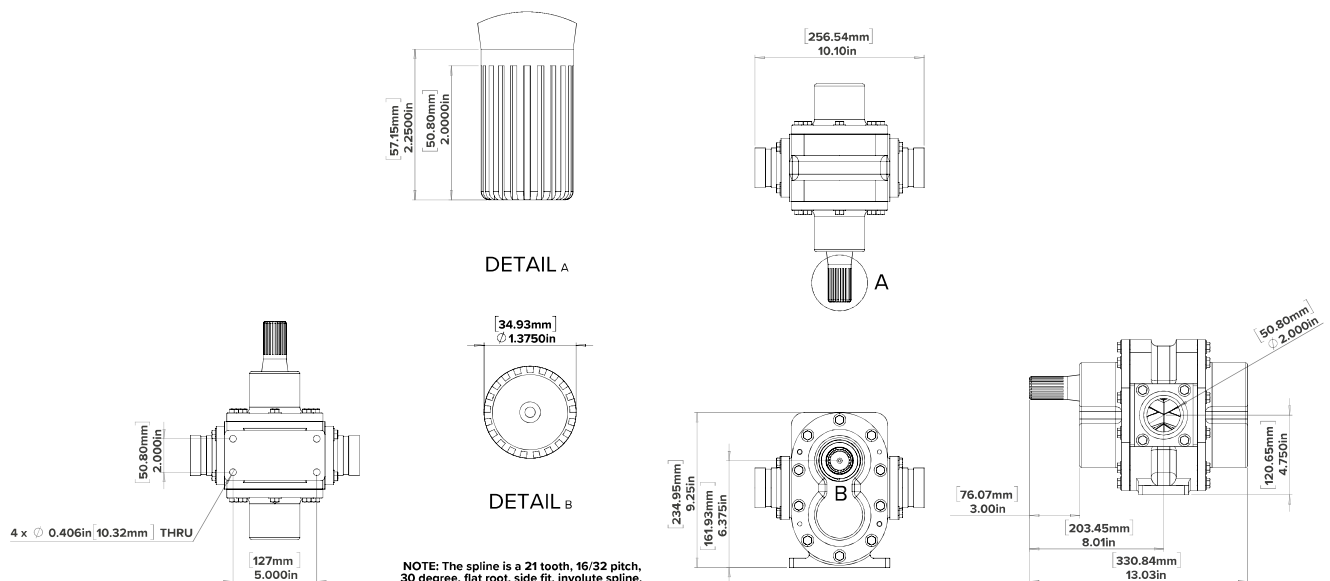

POWER REQUIRED VS DISCHARGE PRESSURE

PORT SIZE: 2"x2"

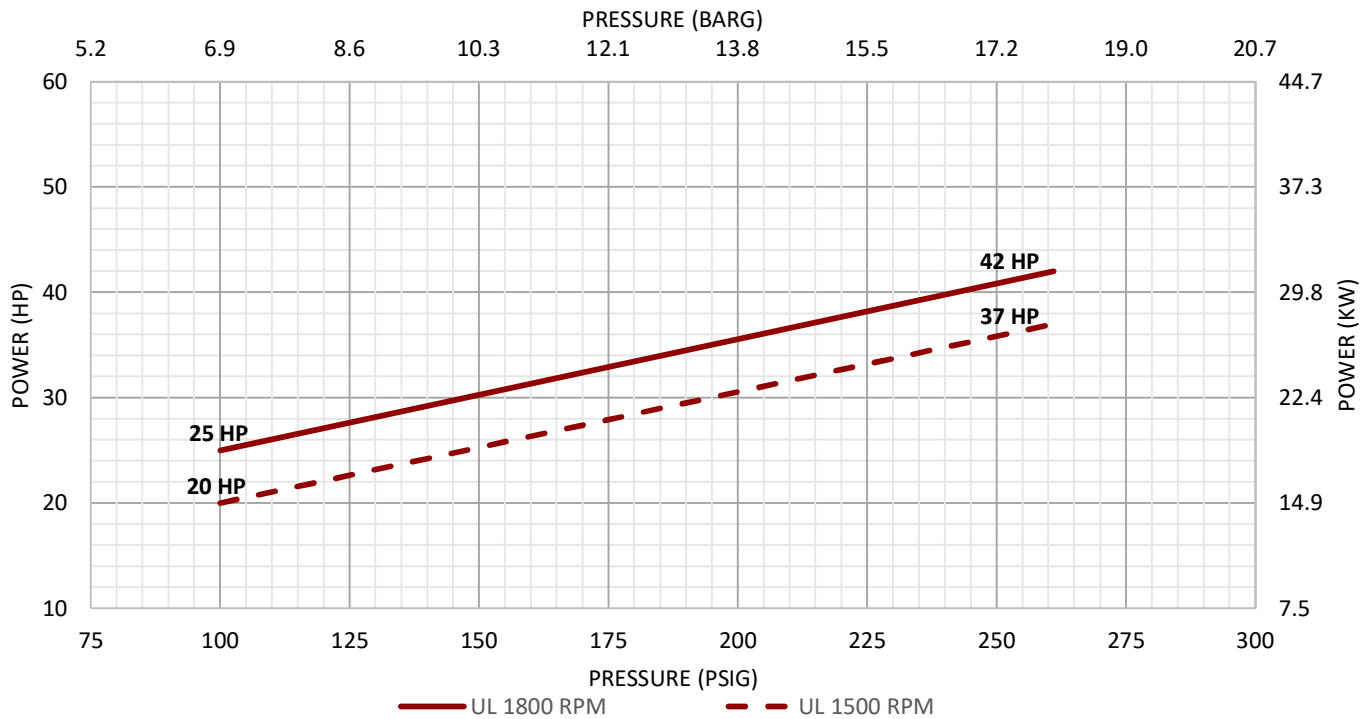

FLOWRATE VS DISCHARGE PRESSURE

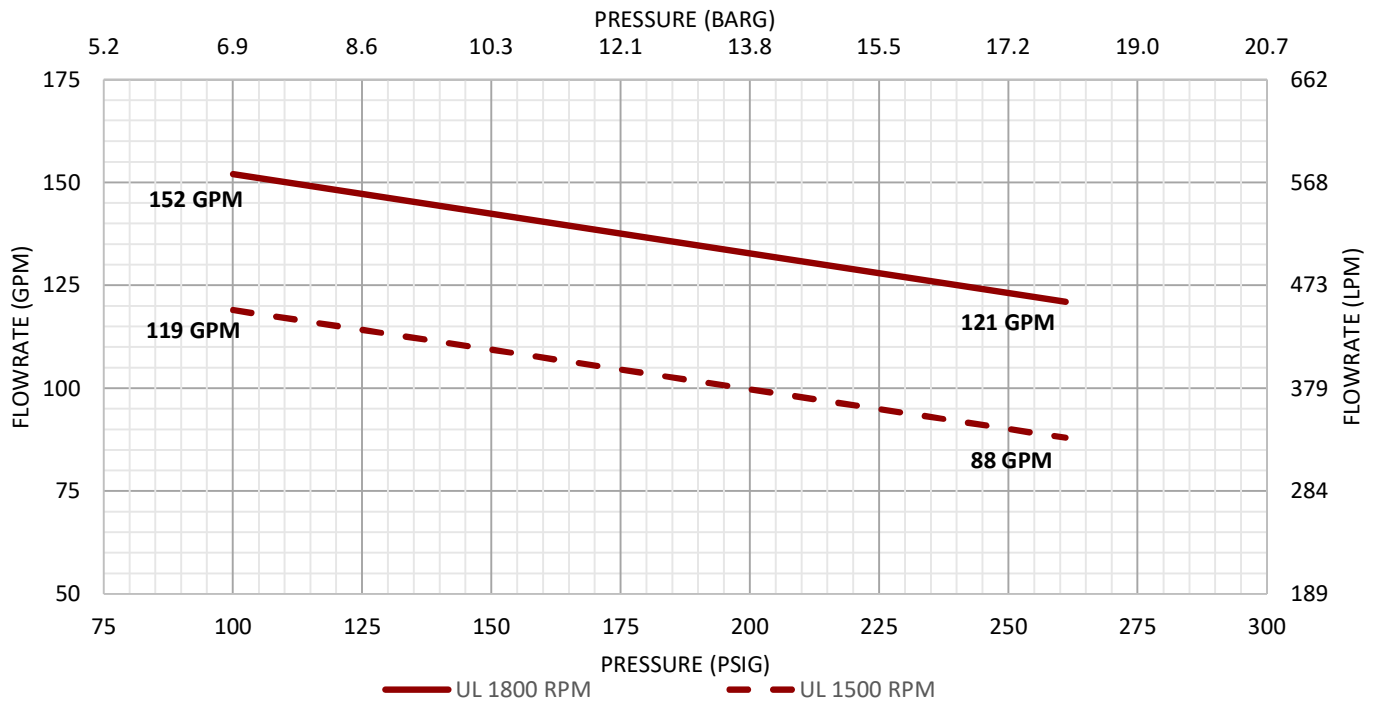

REV-C

FOAM PUMP

MODEL: SD-FP-151

DESCRIPTION

SD-FP-151, is specialized non-corrosive construction pumps used for Fire Protection, especially for Fire-fighting foam concentrate pumping & Water mist pumping applications. These pumps can also be used for Stationary or mobile systems applications.

SHIELD Foam pump have 255 Duplex Stainless steel shafts to withstand seawater flush and any brand foam concentrate. Only 1 shaft seal is permitted and shaft seal shall be capable of dry operation for 10 minutes. Shaft seal shall be simple to repair and replace in the field. Shaft seal materials are 316 stainless casing with double PTFE lips that allow for hydro test pressure to 350 psig without leakage.

Pump rotors shall be Herringbone gear design using corrosion resistant materials. Made from admiralty bronze alloy and composite materials that provide no tooth to tooth wear and no corrosion.

Foam pump connections shall be Groove or Flanged. Pump connections and end covers shall use O-ring seals for leak free operation and simple field replacement.

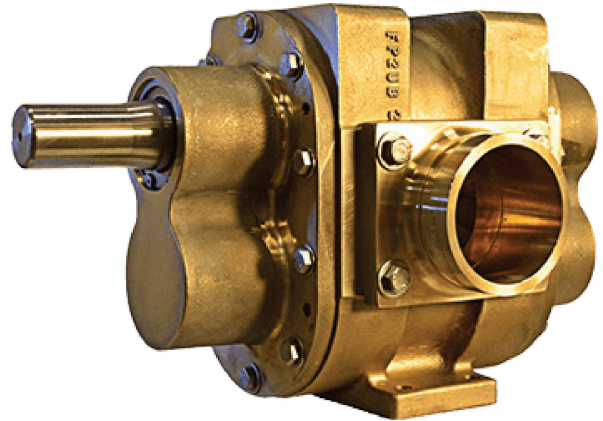

TECHNICAL INFORMATION

RPM	1500	1800
Flow GPM (LPM)	107-140 (406-531)	152-185(387-701)
Pressure psi(kg/cm ²)	261-100(18-7)	261-100(18-7)
Port Size (inch)	2x2	2x2
Material (Body)	Bronze	
Pump Rotor	Herringbone Gear	
Shaft Type	Key Shaft or Splined Input Shaft	
Type of Connection	Flanged, Grooved	
Material (Shaft)	255 Duplex Stainless Steel Shafts	

FEATURES

- Pump is quiet and smooth operation during operation.
- Pump shafts is supported by composite bushings that are field replaceable and capable of extended operation on water or foam concentrate.
- Foam pump design is utilize replaceable casing liners, bearings or timing gears.
- Capable of rotation in either direction without modification.
- UL LISTED & capable of 261(18 bar)psig operation.

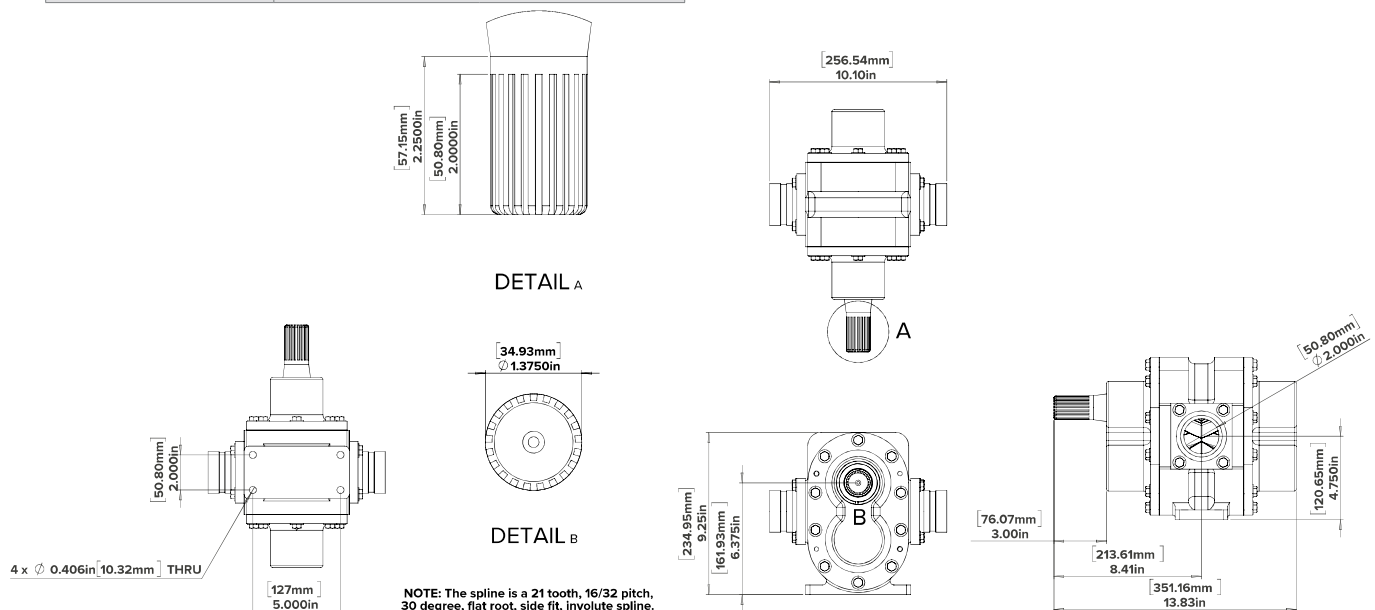

POWER REQUIRED VS DISCHARGE PRESSURE

PORT SIZE: 2"x2"

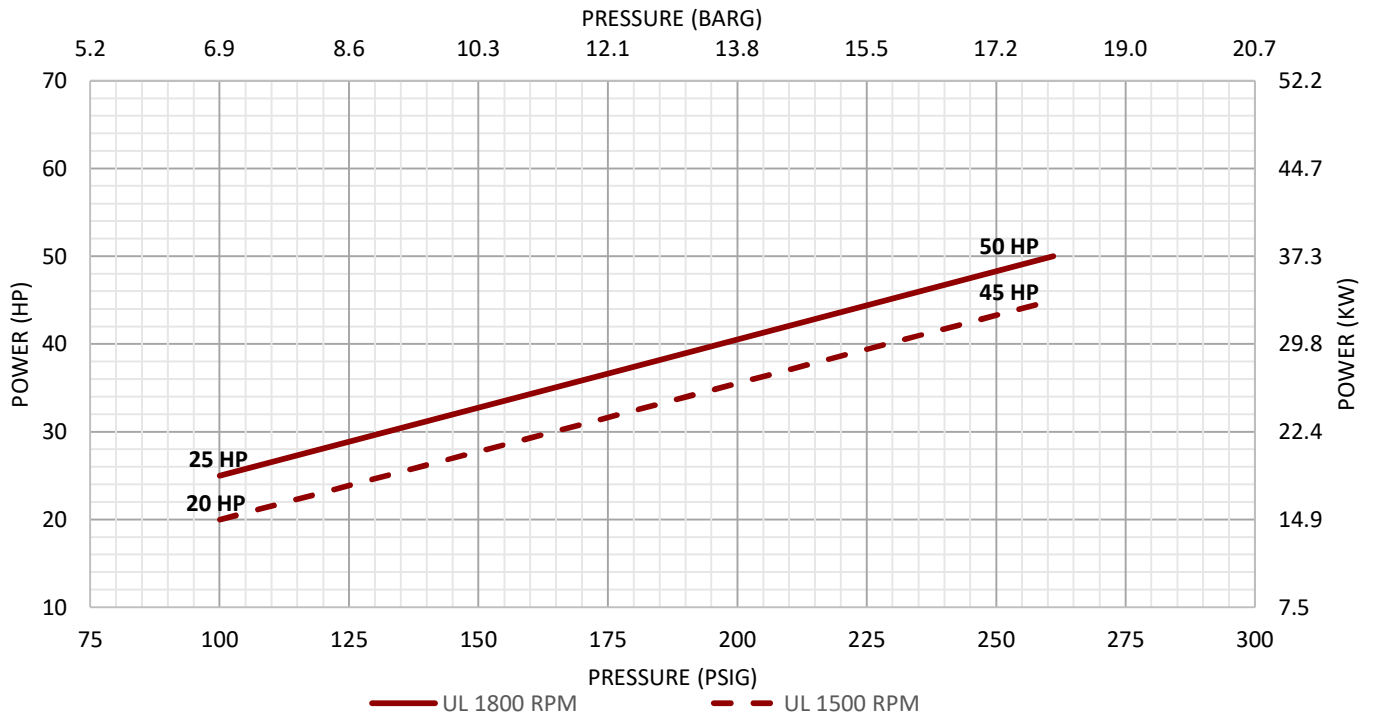

FLOWRATE VS DISCHARGE PRESSURE

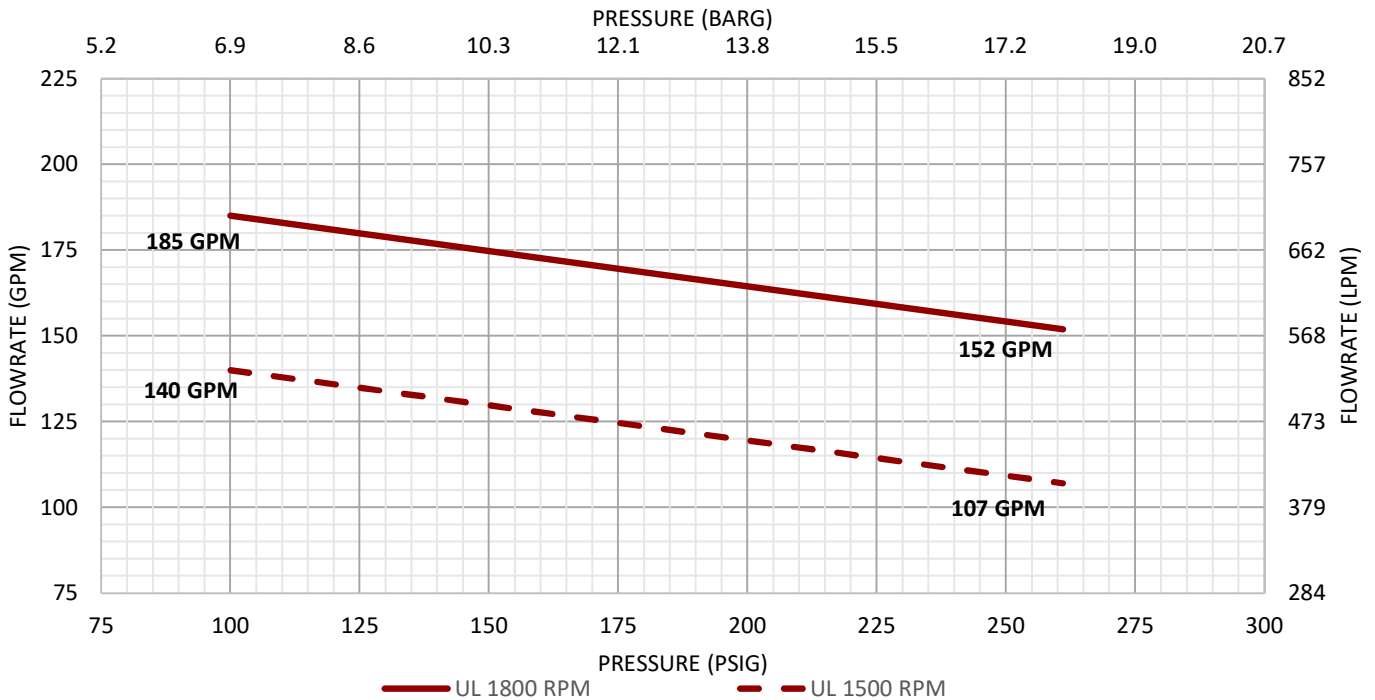

FOAM PUMP

MODEL: SD-FP-175

DESCRIPTION

SD-FP-175, is specialized non-corrosive construction pumps used for Fire Protection, especially for Fire-fighting foam concentrate pumping & Water mist pumping applications. These pumps can also be used for Stationary or mobile systems applications.

SHIELD Foam pump have 255 Duplex Stainless steel shafts to withstand seawater flush and any brand foam concentrate. Only 1 shaft seal is permitted and shaft seal shall be capable of dry operation for 10 minutes. Shaft seal shall be simple to repair and replace in the field. Shaft seal materials are 316 stainless casing with double PTFE lips that allow for hydro test pressure to 350 psig without leakage.

Pump rotors shall be Herringbone gear design using corrosion resistant materials. Made from admiralty bronze alloy and composite materials that provide no tooth to tooth wear and no corrosion.

Foam pump connections shall be Groove or Flanged. Pump connections and end covers shall use O-ring seals for leak free operation and simple field replacement.

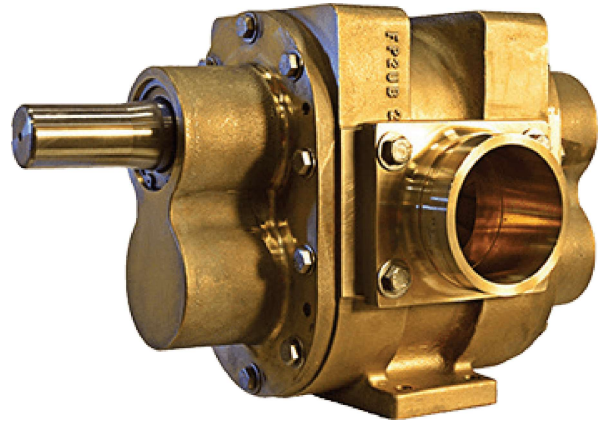

TECHNICAL INFORMATION

RPM	1500	1800
Flow GPM (LPM)	135-180 (512-682)	185-235(701-891)
Pressure psi(kg/cm ²)	261-100(18-7)	261-100(18-7)
Port Size (inch)	3 x 3	3 x 3
Material (Body)	Bronze	
Pump Rotor	Herringbone Gear	
Shaft Type	Key Shaft or Splined Input Shaft	
Type of Connection	Flanged, Grooved	
Material (Shaft)	255 Duplex Stainless Steel Shafts	

FEATURES

- Pump is quiet and smooth operation during operation.
- Pump shafts is supported by composite bushings that are field replaceable and capable of extended operation on water or foam concentrate.
- Foam pump design is utilize replaceable casing liners, bearings or timing gears.
- Capable of rotation in either direction without modification.
- UL LISTED & capable of 261(18 bar)psig operation.

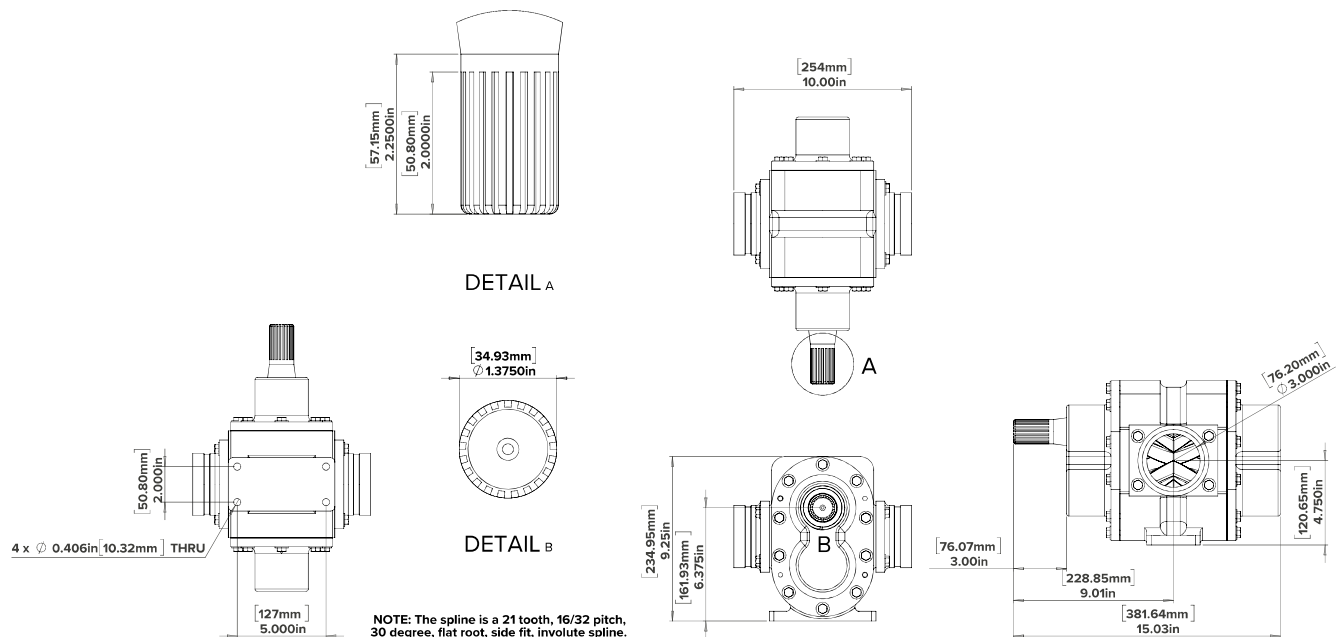

In line with shield policy for continuous product development, shield has the right to change specifications without prior notice.

POWER REQUIRED VS DISCHARGE PRESSURE

PORT SIZE: 3"x3"

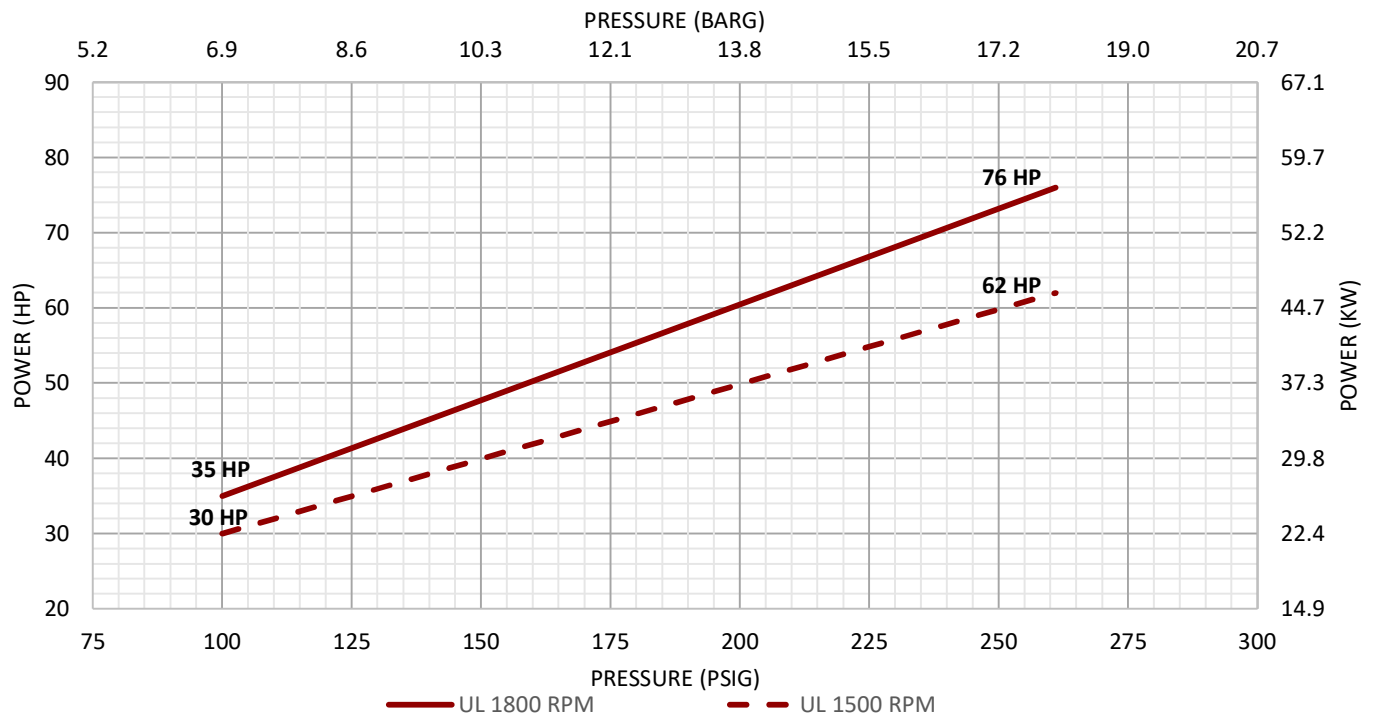

FLOWRATE VS DISCHARGE PRESSURE

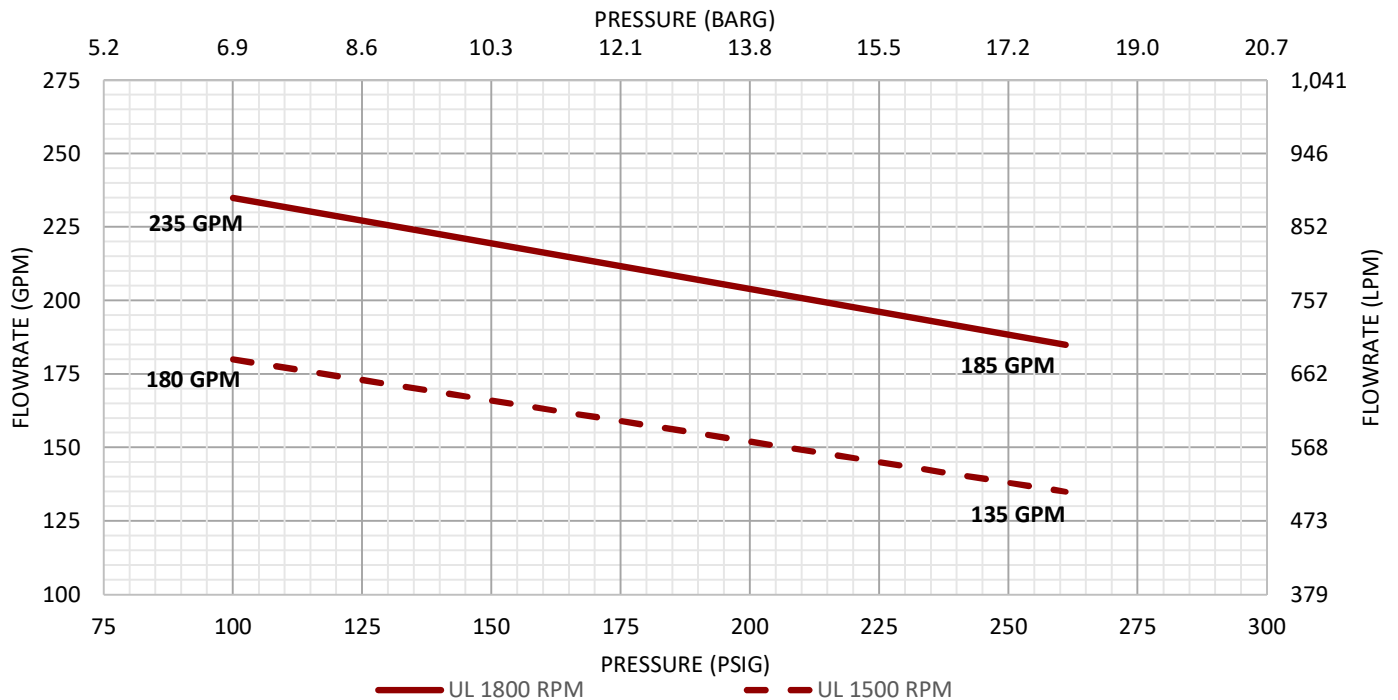

REV-C

FOAM PUMP

MODEL: SD-FP-201

DESCRIPTION

SD-FP-201, is specialized non-corrosive construction pumps used for Fire Protection, especially for Fire-fighting foam concentrate pumping & Water mist pumping applications. These pumps can also be used for Stationary or mobile systems applications.

SHIELD Foam pump have 255 Duplex Stainless steel shafts to withstand seawater flush and any brand foam concentrate. Only 1 shaft seal is permitted and shaft seal shall be capable of dry operation for 10 minutes. Shaft seal shall be simple to repair and replace in the field. Shaft seal materials are 316 stainless casing with double PTFE lips that allow for hydro test pressure to 350 psig without leakage.

Pump rotors shall be Herringbone gear design using corrosion resistant materials. Made from admiralty bronze alloy and composite materials that provide no tooth to tooth wear and no corrosion.

Foam pump connections shall be Groove or Flanged. Pump connections and end covers shall use O-ring seals for leak free operation and simple field replacement.

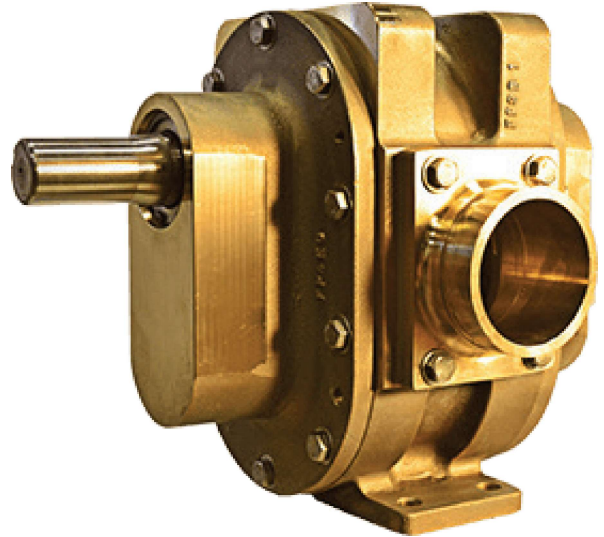

TECHNICAL INFORMATION

RPM	1500	1800
Flow GPM (LPM)	158-205 (599-777)	202-252(766-955)
Pressure psi(kg/cm ²)	261-100(18-7)	261-100(18-7)
Port Size (inch)	3 x 3	3 x 3
Material (Body)	Bronze	
Pump Rotor	Herringbone Gear	
Shaft Type	Key Shaft or Splined Input Shaft	
Type of Connection	Flanged, Grooved	
Material (Shaft)	255 Duplex Stainless Steel Shafts	

FEATURES

- Pump is quiet and smooth operation during operation.
- Pump shafts is supported by composite bushings that are field replaceable and capable of extended operation on water or foam concentrate.
- Foam pump design is utilize replaceable casing liners, bearings or timing gears.
- Capable of rotation in either direction without modification.
- UL LISTED & capable of 261(18 bar)psig operation.

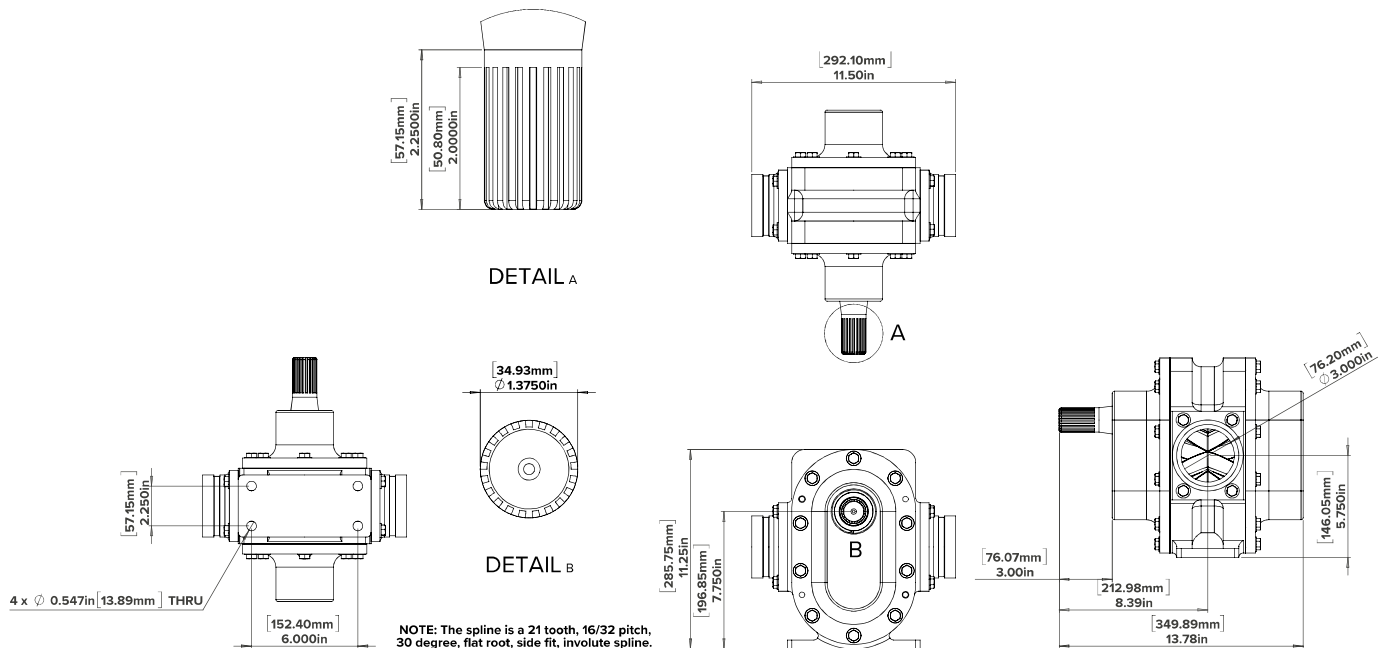

In line with shield policy for continuous product development, shield has the right to change specifications without prior notice.

POWER REQUIRED VS DISCHARGE PRESSURE

PORT SIZE: 3"x3"

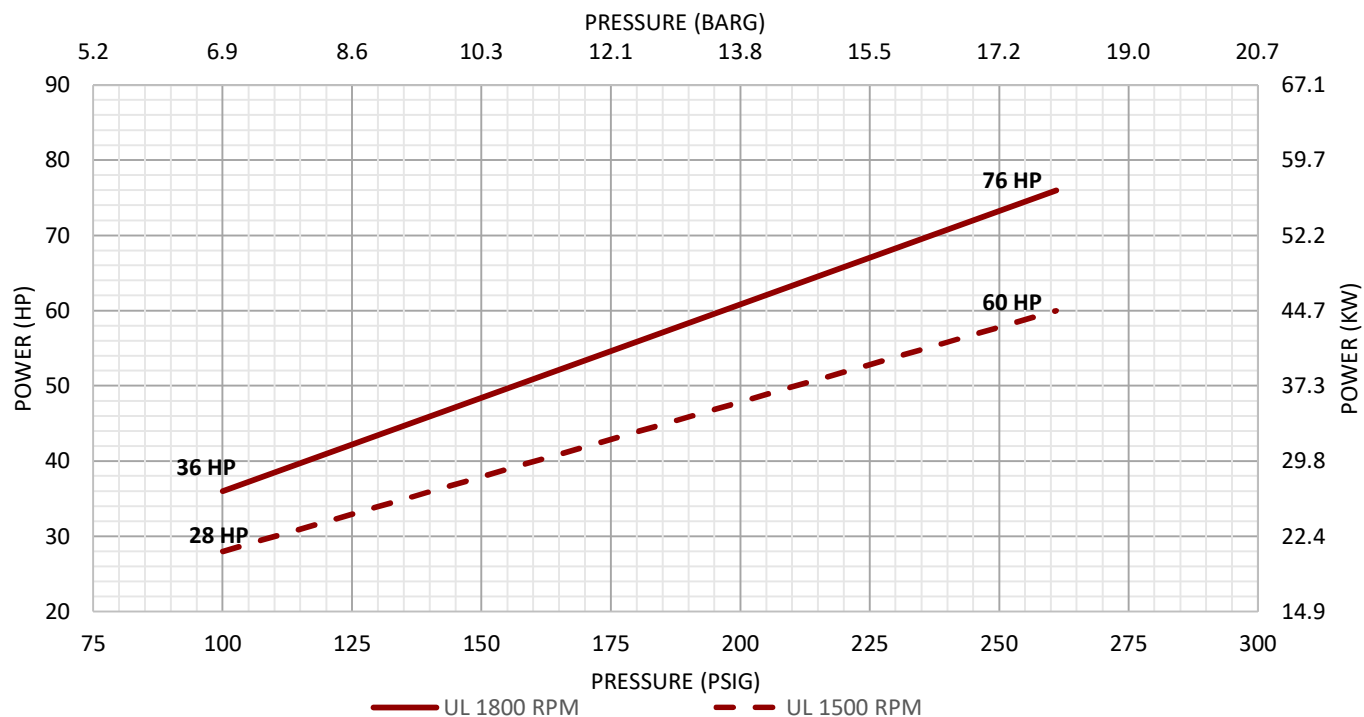

FLOWRATE VS DISCHARGE PRESSURE

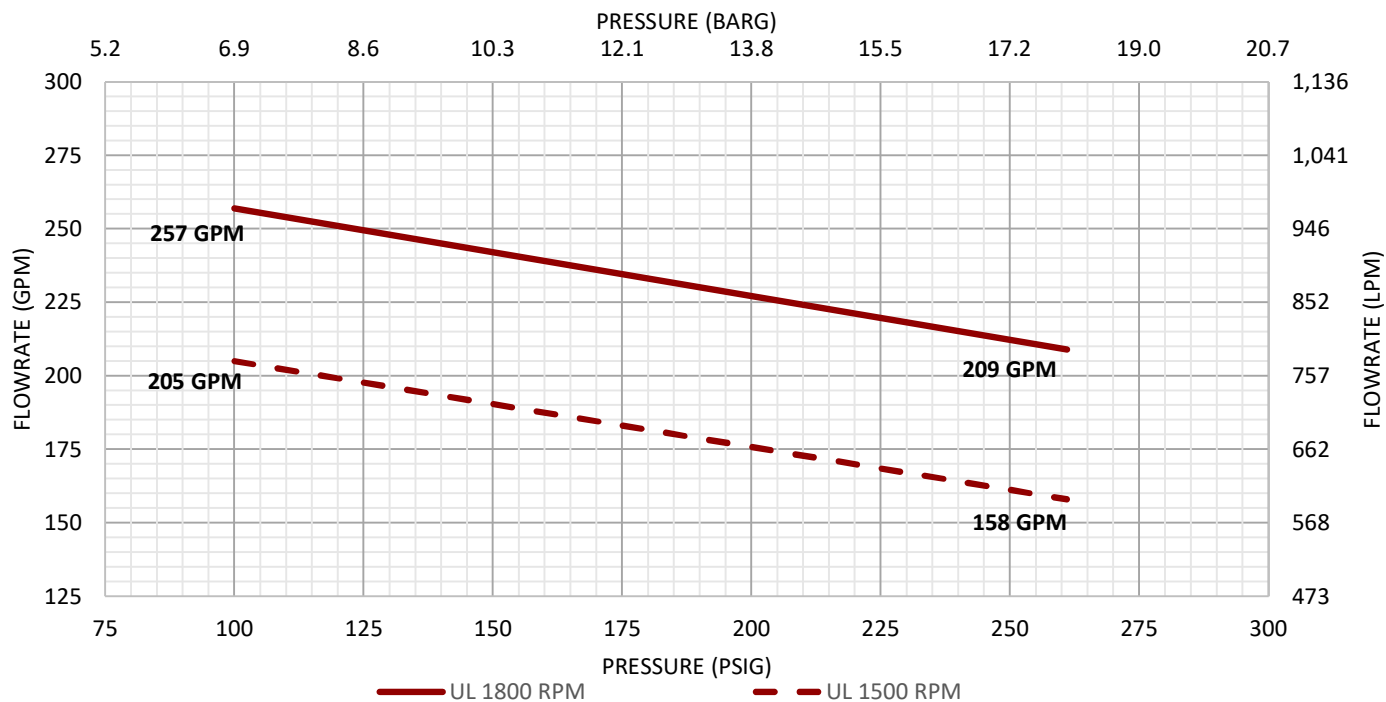

FOAM PUMP

MODEL: SD-FP-225

DESCRIPTION

SD-FP-225, is specialized non-corrosive construction pumps used for Fire Protection, especially for Fire-fighting foam concentrate pumping & Water mist pumping applications. These pumps can also be used for Stationary or mobile systems applications.

SHIELD Foam pump have 255 Duplex Stainless steel shafts to withstand seawater flush and any brand foam concentrate. Only 1 shaft seal is permitted and shaft seal shall be capable of dry operation for 10 minutes. Shaft seal shall be simple to repair and replace in the field. Shaft seal materials are 316 stainless casing with double PTFE lips that allow for hydro test pressure to 350 psig without leakage.

Pump rotors shall be Herringbone gear design using corrosion resistant materials. Made from admiralty bronze alloy and composite materials that provide no tooth to tooth wear and no corrosion. Foam pump connections shall be Groove or Flanged. Pump connections and end covers shall use O-ring seals for leak free operation and simple field replacement.

TECHNICAL INFORMATION

RPM	1500	1800
Flow GPM (LPM)	180-240 (682-910)	240-300(910-1137)
Pressure psi(kg/cm ²)	261-100(18-7)	261-100(18-7)
Port Size (inch)	3 x 3	3 x 3
Material (Body)	Bronze	
Pump Rotor	Herringbone Gear	
Shaft Type	Key Shaft or Splined Input Shaft	
Type of Connection	Flanged, Grooved	
Material (Shaft)	255 Duplex Stainless Steel Shafts	

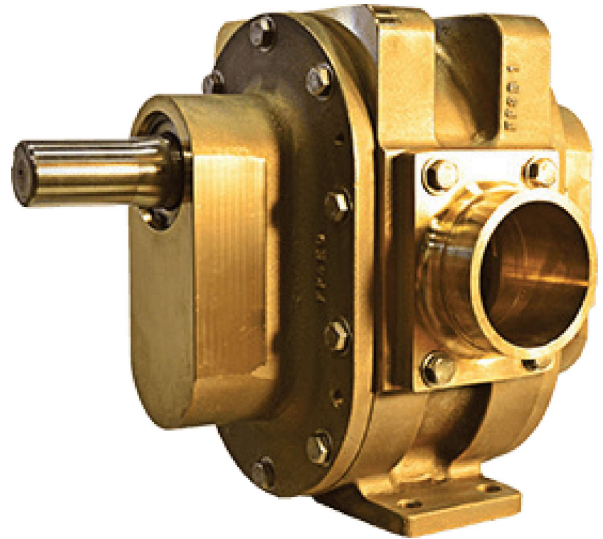

FEATURES

- Pump is quiet and smooth operation during operation.
- Pump shafts is supported by composite bushings that are field replaceable and capable of extended operation on water or foam concentrate.
- Foam pump design is utilize replaceable casing liners, bearings or timing gears.
- Capable of rotation in either direction without modification.
- UL LISTED & capable of 261(18 bar)psig operation.

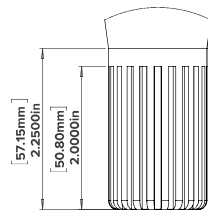

DETAIL A

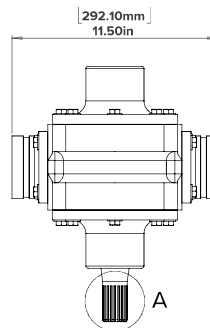

A

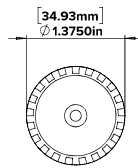

DETAIL B

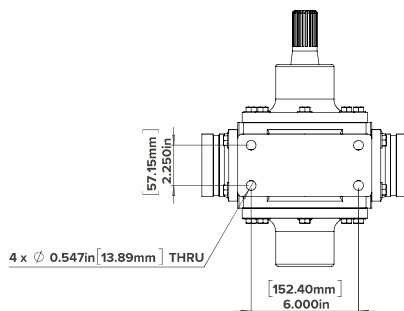

NOTE: The spline is a 21 tooth, 16/32 pitch, 30 degree, flat root, side fit, involute spline.

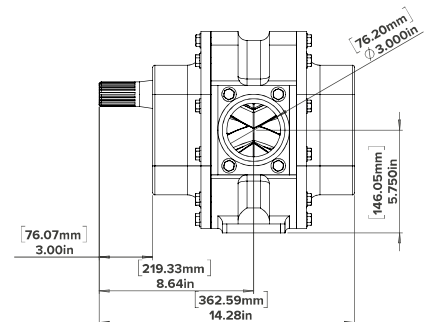
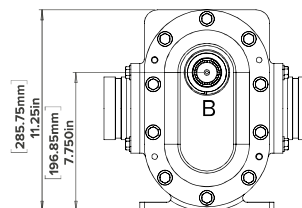

In line with shield policy for continuous product development, shield has the right to change specifications without prior notice.

POWER REQUIRED VS DISCHARGE PRESSURE

PORT SIZE: 3"x3"

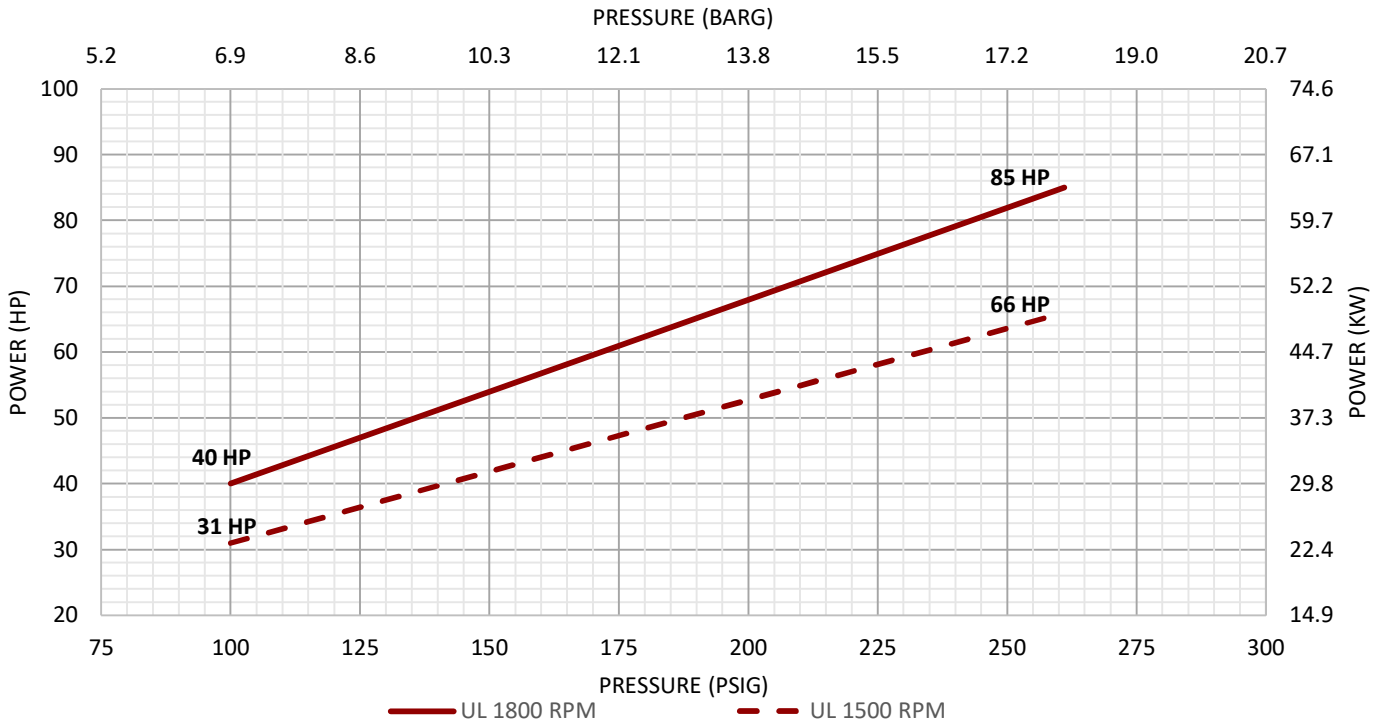

FLOWRATE VS DISCHARGE PRESSURE

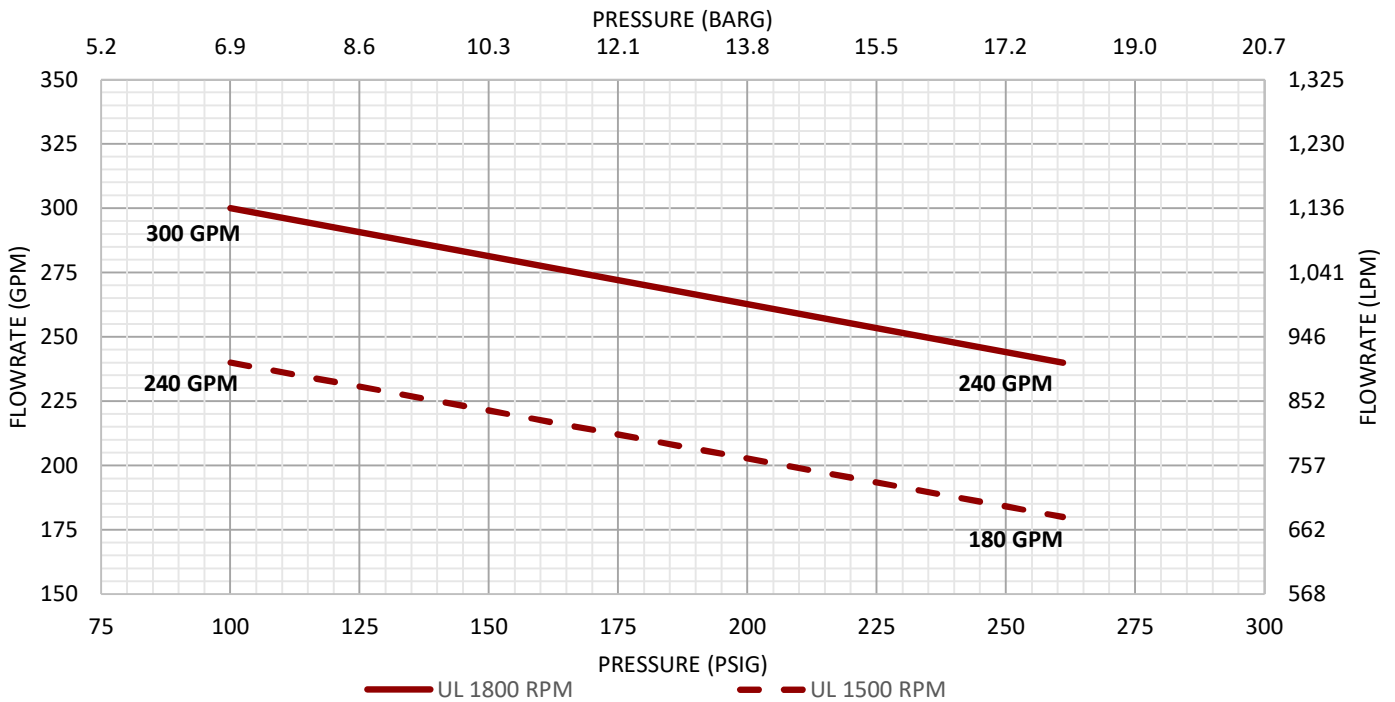

FOAM PUMP

MODEL: SD-FP-250

DESCRIPTION

SD-FP-250, is specialized non-corrosive construction pumps used for Fire Protection, especially for Fire-fighting foam concentrate pumping & Water mist pumping applications. These pumps can also be used for Stationary or mobile systems applications.

SHIELD Foam pump have 255 Duplex Stainless steel shafts to withstand seawater flush and any brand foam concentrate. Only 1 shaft seal is permitted and shaft seal shall be capable of dry operation for 10 minutes. Shaft seal shall be simple to repair and replace in the field. Shaft seal materials are 316 stainless casing with double PTFE lips that allow for hydro test pressure to 350 psig without leakage.

Pump rotors shall be Herringbone gear design using corrosion resistant materials. Made from admiralty bronze alloy and composite materials that provide no tooth to tooth wear and no corrosion.

Foam pump connections shall be Groove or Flanged. Pump connections and end covers shall use O-ring seals for leak free operation and simple field replacement.

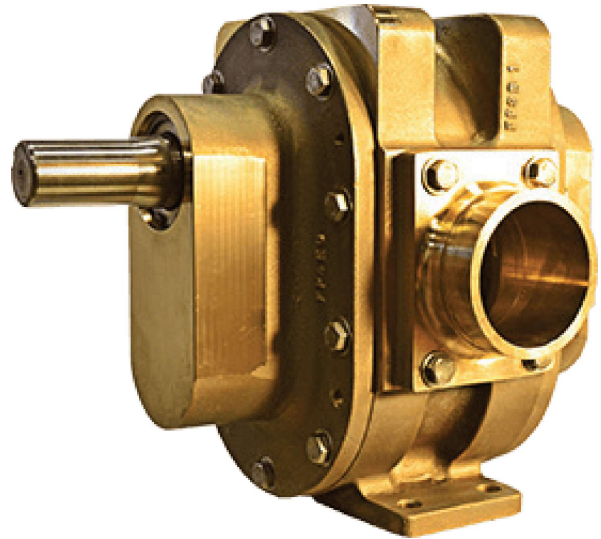

TECHNICAL INFORMATION

RPM	1500	1800
Flow GPM (LPM)	185-245 (701-925)	250-315(948-1194)
Pressure psi(kg/cm ²)	261-100(18-7)	261-100(18-7)
Port Size (inch)	4x4	4x4
Material (Body)	Bronze	
Pump Rotor	Herringbone Gear	
Shaft Type	Key Shaft or Splined Input Shaft	
Type of Connection	Flanged, Grooved	
Material (Shaft)	255 Duplex Stainless Steel Shafts	

FEATURES

- Pump is quiet and smooth operation during operation.
- Pump shafts is supported by composite bushings that are field replaceable and capable of extended operation on water or foam concentrate.
- Foam pump design is utilize replaceable casing liners, bearings or timing gears.
- Capable of rotation in either direction without modification.
- UL LISTED & capable of 261(18 bar)psig operation.

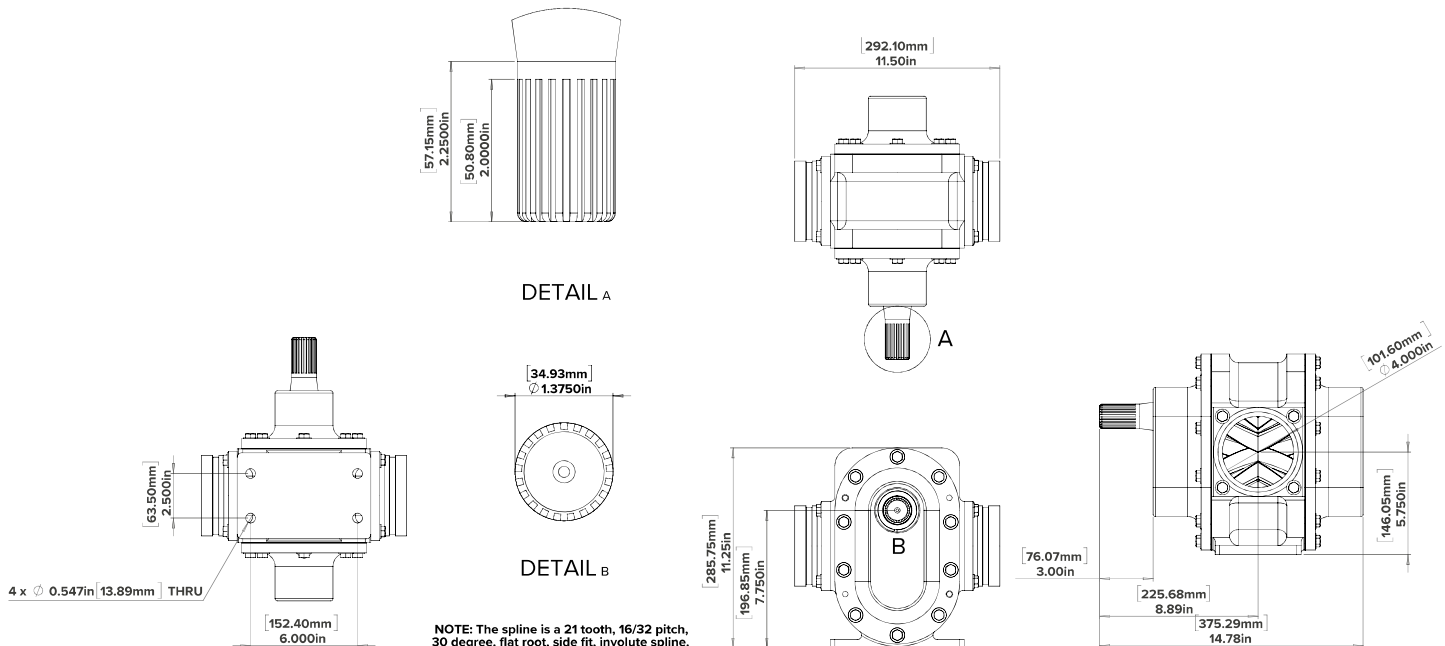

In line with shield policy for continuous product development, shield has the right to change specifications without prior notice.

POWER REQUIRED VS DISCHARGE PRESSURE

PORT SIZE: 4"x4"

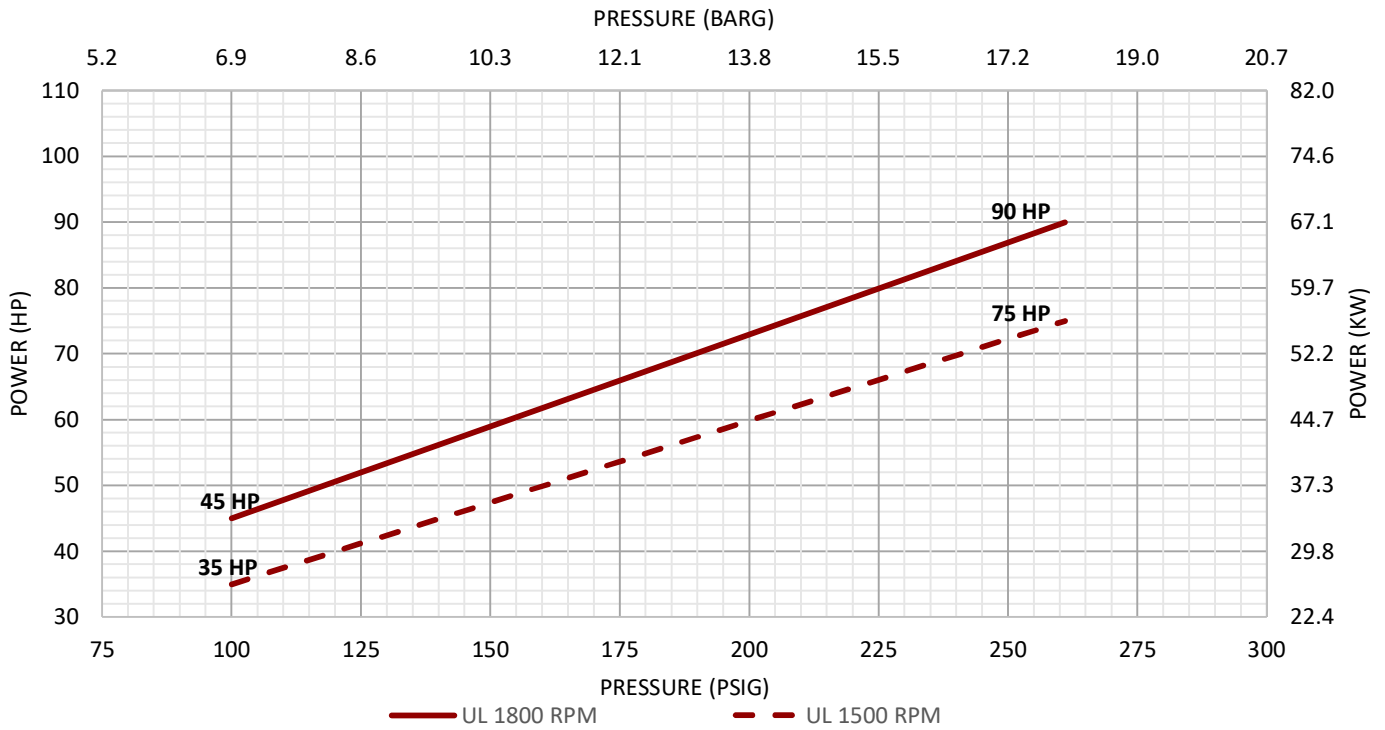

FLOWRATE VS DISCHARGE PRESSURE

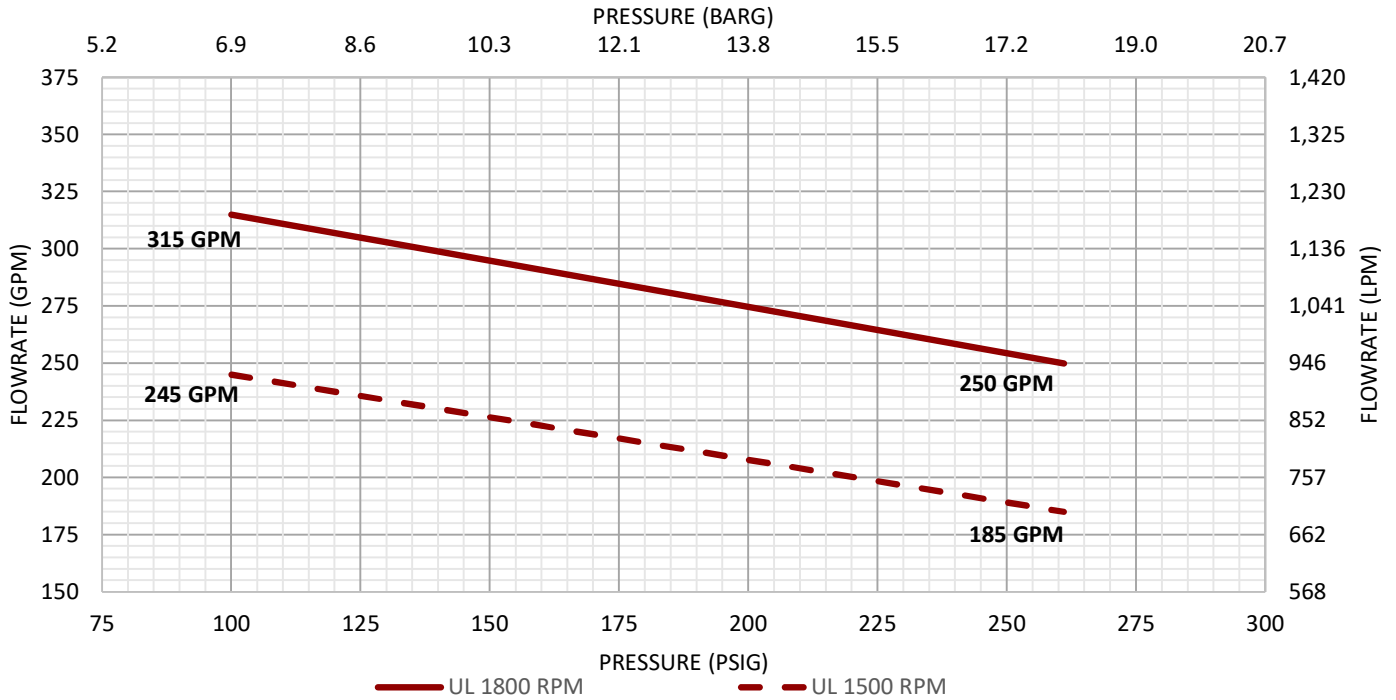

FOAM PUMP

MODEL: SD-FP-350

DESCRIPTION

SD-FP-350, is specialized non-corrosive construction pumps used for Fire Protection, especially for Fire-fighting foam concentrate pumping & Water mist pumping applications. These pumps can also be used for Stationary or mobile systems applications.

SHIELD Foam pump have 255 Duplex Stainless steel shafts to withstand seawater flush and any brand foam concentrate. Only 1 shaft seal is permitted and shaft seal shall be capable of dry operation for 10 minutes. Shaft seal shall be simple to repair and replace in the field. Shaft seal materials are 316 stainless casing with double PTFE lips that allow for hydro test pressure to 350 psig without leakage.

Pump rotors shall be Herringbone gear design using corrosion resistant materials. Made from admiralty bronze alloy and composite materials that provide no tooth to tooth wear and no corrosion.

Foam pump connections shall be Groove or Flanged.

Pump connections and end covers shall use O-ring seals for leak free operation and simple field replacement.

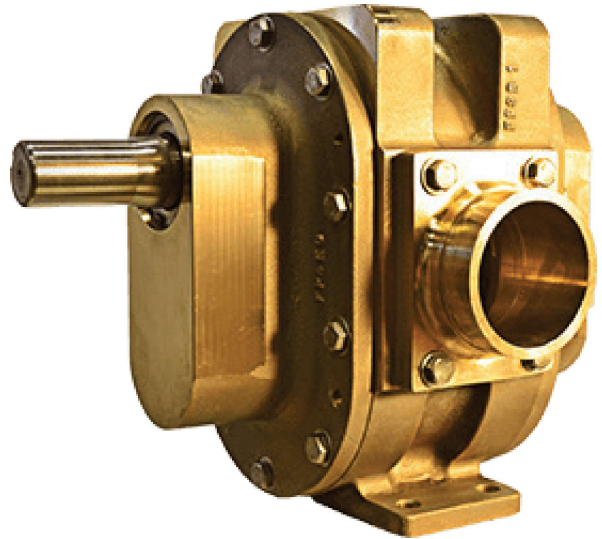

TECHNICAL INFORMATION

RPM	1500	1800
Flow GPM (LPM)	280-335 (1061-1270)	375-420(1421-1592)
Pressure psi(kg/cm ²)	232-100(16-7)	232-100(16-7)
Port Size (inch)	4x4	4x4
Material (Body)	Bronze	
Pump Rotor	Herringbone Gear	
Shaft Type	Key Shaft or Splined Input Shaft	
Type of Connection	Flanged, Grooved	
Material (Shaft)	255 Duplex Stainless Steel Shafts	

FEATURES

- Pump is quiet and smooth operation during operation.
- Pump shafts is supported by composite bushings that are field replaceable and capable of extended operation on water or foam concentrate.
- Foam pump design is utilize replaceable casing liners, bearings or timing gears.
- Capable of rotation in either direction without modification.
- UL LISTED & capable of 261(18 bar)psig operation.

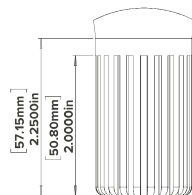

DETAIL A

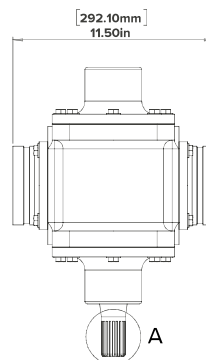

A

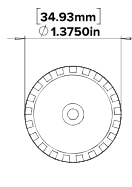
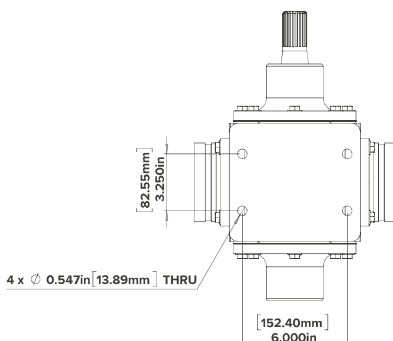

DETAIL B

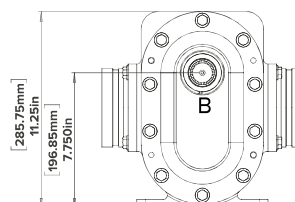

B

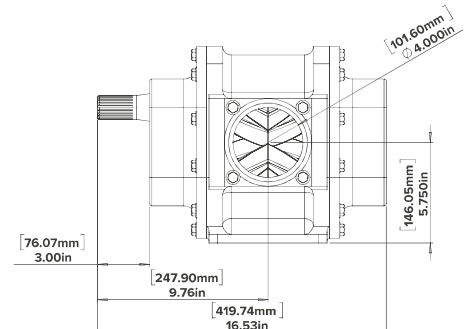

NOTE: The spline is a 21 tooth, 16/32 pitch, 30 degree, flat root, side fit, involute spline.

In line with shield policy for continuous product development, shield has the right to change specifications without prior notice.

POWER REQUIRED VS DISCHARGE PRESSURE

PORT SIZE: 4"x4"

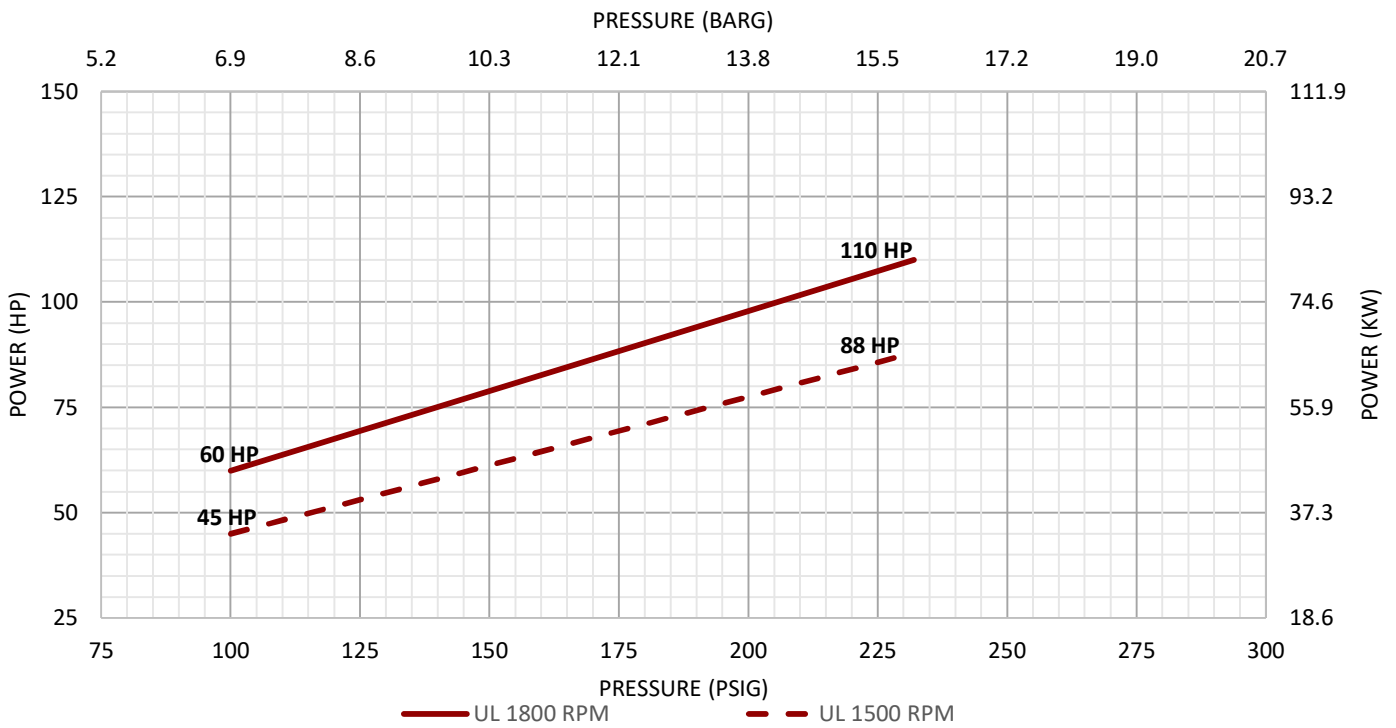

FLOWRATE VS DISCHARGE PRESSURE

